

Date: 07/02/18

Time: 09:46:04

Check Dates 07/12/02 - 06/29/18

Shaler Area School District

SUPPLEMENT C.1A CHECK LIST

06/31/2018 2017-2018

Page: 1

BAR055

Check # 00001000 - 99995183

Check	Date	Vendor#	Vendor Name	P.O.	F/P	Inv Date	Invoice #	Check Amount	Batch	Src	Stat
10-0101.002.000.00.00 Cash - PNC Bank											
10180762	06/01/18	MCE21	SUE MCELHINNY					\$156.87	20180601	CC	O
			MILEAGE JANUARY THROUGH JUNE 2510580 / 10-2519.580.000.00.00			06/01/18	SPRING 2018	156.87			
			1, 2018								
10180763	06/08/18	ZZ29	RONDA J. WINNECOUR					\$1,621.66	20180691	CC	O
			EMPLOYEE - GARNISHMENT - E FOR047025 / 10-0470.025.000.00.00			06/08/18	PY-VD13E-20180608P	1,621.66			
			CHAPTER 13								
10180764	06/08/18	ZZ06	NORTH DISTRICTS COMMUNITY CREDIT UNION					\$93,285.74	20180691	CC	O
			EMPLOYEE - CREDIT UNION 047042 / 10-0470.042.000.00.00			06/08/18	PY-VD07-20180608P	93,285.74			
10180765	06/08/18	ZZ16	TEAMSTERS LOCAL 205					\$3,288.00	20180691	CC	O
			EMPLOYEE - CUSTODIAN DUES 047032 / 10-0470.032.000.00.00			06/08/18	PY-VD06-20180608P	3,288.00			
10180766	06/08/18	ZZ17	TEAMSTERS LOCAL 205					\$1,228.00	20180691	CC	O
			EMPLOYEE - CLERICAL DUES 047031 / 10-0470.031.000.00.00			06/08/18	PY-VD05-20180608P	1,228.00			
10180767	06/08/18	GAPAL	Great American Plan Administrators Inc					\$78,669.57	20180691	CC	O
			EMPLOYEE - T.S.A. - G FOR EMPLOYEE BENEFIT/GWN 04701 / 10-0470.001.000.00.00			06/08/18	PY-VD01G-20180608P	5,150.00			
			EMPLOYEE - T.S.A. - E FOR AMERICAN FUNDS 04701 / 10-0470.001.000.00.00			06/08/18	PY-VD01E-20180608P	5,175.15			
			EMPLOYEE - T.S.A. - ING (AETNA) 04701 / 10-0470.001.000.00.00			06/08/18	PY-VD01I-20180608P	14,085.85			
			EMPLOYEE - T.S.A. - C FOR LINCOLN INVESTMENT 04701 / 10-0470.001.000.00.00			06/08/18	PY-VD01C-20180608P	18,791.36			
			EMPLOYEE - T.S.A. - L FOR EQUITABLE-AXA 04701 / 10-0470.001.000.00.00			06/08/18	PY-VD01L-20180608P	12,282.00			
			EMPLOYEE - T.S.A. - M FOR LINCOLN FINANCIAL 04701 / 10-0470.001.000.00.00			06/08/18	PY-VD01M-20180608P	2,089.53			
			EMPLOYEE - T.S.A. - N FOR PLAN04701 / 10-0470.001.000.00.00			06/08/18	PY-VD01N-20180608P	150.00			
			MBR SVSC								
			EMPLOYEE - ROTH - 6 FOR EQUITABLE-AXA 04701 / 10-0470.001.000.00.00			06/08/18	PY-VR06-20180608P	46.00			
			EMPLOYEE - ROTH - 5 FOR WAD & REED 04701 / 10-0470.001.000.00.00			06/08/18	PY-VR05-20180608P	50.00			
			EMPLOYEE - ROTH - 4 FOR LINCOLN FINANCIAL 04701 / 10-0470.001.000.00.00			06/08/18	PY-VR04-20180608P	8,784.11			

Date: 07/02/18

Time: 09:46:04

Check Dates 07/12/02 - 06/29/18

Shaler Area School District
SUPPLEMENT C.1A CHECK LIST
06/31/2018 2017-2018

Page: 2

BAR055

Check # 00001000 - 99995183

Check	Date	Vendor#	Vendor Name	P.O.	F/P	Inv Date	Invoice #	Check Amount	Batch	Src	Stat
10-0101.002.000.00.00 Cash - PNC Bank											
10180767	06/08/18	GAPA1	Great American Plan Administrators Inc					\$78,669.57	20180691	CC	O
			EMPLOYEE - T.S.A. - R FOR WADDELL AND REED	04701 / 10-0470.001.000.00.00		06/08/18	PY-VD01R-20180608P	6,887.50			
			EMPLOYEE - T.S.A. - Q FOR FIDELITY INVESTMENT	04701 / 10-0470.001.000.00.00		06/08/18	PY-VD01Q-20180608P	3,323.07			
			EMPLOYEE - ROTH - 1 FOR EMPLOYEE BENEFIT	04701 / 10-0470.001.000.00.00		06/08/18	PY-VR01-20180608P	1,430.00			
			EMPLOYEE - ROTH - 3 FOR LINCOLN INVESTMENTS	04701 / 10-0470.001.000.00.00		06/08/18	PY-VR03-20180608P	425.00			
10180768	06/08/18	ZZ70	WINDHAM PROFESSIONALS INC					\$119.00	20180691	CC	O
			EMPLOYEE - STUDENT LOAN ATTACHMENT/WINDHAM	047025 / 10-0470.025.000.00.00		06/08/18	PY-VD22-20180608P	119.00			
10180769	06/22/18	ZZ29	RONDA J. WINNECOUR					\$1,394.66	20180692	CC	O
			EMPLOYEE - GARNISHMENT - E FOR CHAPTER 13	047025 / 10-0470.025.000.00.00		06/22/18	PY-VD13E-20180622P	1,394.66			
10180770	06/22/18	ZZ06	NORTH DISTRICTS COMMUNITY CREDIT UNION					\$30,551.10	20180692	CC	O
			EMPLOYEE - CREDIT UNION	047042 / 10-0470.042.000.00.00		06/22/18	PY-VD07-20180622P	30,551.10			
10180771	06/22/18	ZZ16	TEAMSTERS LOCAL 205					\$67.00	20180692	CC	O
			EMPLOYEE - CUSTODIAN DUES	047032 / 10-0470.032.000.00.00		06/22/18	PY-VD06-20180622P	67.00			
10180772	06/22/18	GAPA1	Great American Plan Administrators Inc					\$17,919.03	20180692	CC	O
			EMPLOYEE - ROTH - 4 FOR LINCOLN FINANCIAL	04701 / 10-0470.001.000.00.00		06/22/18	PY-VR04-20180622P	1,519.21			
			EMPLOYEE - ROTH - 3 FOR LINCOLN INVESTMENTS	04701 / 10-0470.001.000.00.00		06/22/18	PY-VR03-20180622P	425.00			
			EMPLOYEE - T.S.A. - Q FOR FIDELITY INVESTMENT	04701 / 10-0470.001.000.00.00		06/22/18	PY-VD01Q-20180622P	2,073.07			
			EMPLOYEE - T.S.A. - N FOR MBR SVSC	04701 / 10-0470.001.000.00.00		06/22/18	PY-VD01N-20180622P	150.00			
			EMPLOYEE - T.S.A. - R FOR WADDELL AND REED	04701 / 10-0470.001.000.00.00		06/22/18	PY-VD01R-20180622P	2,790.00			
			EMPLOYEE - ROTH - 1 FOR EMPLOYEE BENEFIT	04701 / 10-0470.001.000.00.00		06/22/18	PY-VR01-20180622P	100.00			

Date: 07/02/18

Time: 09:46:04

Check Dates 07/12/02 - 06/29/18

Shaler Area School District

SUPPLEMENT C.1A CHECK LIST

06/31/2018 2017-2018

Page: 3

BAR055

Check # 00001000 - 99995183

Check	Date	Vendor#	Vendor Name	P.O.	F/P	Inv Date	Invoice #	Check Amount	Batch	Src	Stat
10-0101.002.000.00.00 Cash - PNC Bank											
10180772	06/22/18	GAPA1	Great American Plan Administrators Inc					\$17,919.03	20180692	CC	O
			EMPLOYEE - ROTH - 5 FOR WAD & REED	04701 / 10-0470.001.000.00.00		06/22/18	PY-VR05-20180622P	50.00			
			EMPLOYEE - ROTH - 6 FOR EQUITABLE-AXA	04701 / 10-0470.001.000.00.00		06/22/18	PY-VR06-20180622P	46.00			
			EMPLOYEE - T.S.A. - M FOR LINCOLN FINANCIAL	04701 / 10-0470.001.000.00.00		06/22/18	PY-VD01M-20180622P	2,099.73			
			EMPLOYEE - T.S.A. - ING (AETNA)	04701 / 10-0470.001.000.00.00		06/22/18	PY-VD01I-20180622P	1,238.02			
			EMPLOYEE - T.S.A. - L FOR EQUITABLE-AXA	04701 / 10-0470.001.000.00.00		06/22/18	PY-VD01L-20180622P	1,658.00			
			EMPLOYEE - T.S.A. - C FOR LINCOLN INVESTMENT	04701 / 10-0470.001.000.00.00		06/22/18	PY-VD01C-20180622P	3,045.00			
			EMPLOYEE - T.S.A. - E FOR AMERICAN FUNDS	04701 / 10-0470.001.000.00.00		06/22/18	PY-VD01E-20180622P	1,775.00			
			EMPLOYEE - T.S.A. - G FOR EMPLOYEE BENEFIT/GWN	04701 / 10-0470.001.000.00.00		06/22/18	PY-VD01G-20180622P	950.00			
10180983	06/21/18	HAR30	HARTDIANE					\$49.40	20180601	CC	O
			REIMBURSEMENT FOR POSTAGE FOR OVERNIGHT DELIVERY	2519610 / 10-2519.610.000.00.00		06/21/18	4131920244-1	24.70			
			REIMBURSEMENT FOR NEXT DAY DELIVERY TO PA DEPT OF EDUCATION	2519610 / 10-2519.610.000.00.00		06/18/18	4131920244	24.70			
10180984	06/21/18	UNI40	UNIVERSITY OF PITTSBURGH					\$900.00	20180601	CC	O
			MEMBERSHIP DUES - 7/1/18 - 6/30/19	2360810 / 10-2360.810.000.00.00		05/07/18	902	900.00			
10180985	06/29/18	ZZ32	NATIONAL D.R.I.V.E.					\$8.00	20180698	CC	O
			EMPLOYEE - National D.R.I.V.E.	047031 / 10-0470.031.000.00.00		06/08/18	PY-VD23-20180608M	4.00			
			EMPLOYEE - National D.R.I.V.E.	047031 / 10-0470.031.000.00.00		06/22/18	PY-VD23-20180622M	4.00			
10180986	06/29/18	ZZ24	TUITION ACCOUNT PROG BUR					\$2,470.00	20180698	CC	O
			EMPLOYEE - TUITION-TAP 529	047060 / 10-0470.060.000.00.00		06/08/18	PY-VD18-20180608M	1,410.00			
			EMPLOYEE - TUITION-TAP 529	047060 / 10-0470.060.000.00.00		06/22/18	PY-VD18-20180622M	1,060.00			
10180987	06/29/18	ZZ31	Sun Life Assurance Co of Canada (U.S.)					\$11,574.40	20180698	CC	O

Date: 07/02/18
 Time: 09:46:05
 Check Dates 07/12/02 - 06/29/18

Shaler Area School District
 SUPPLEMENT C.1A CHECK LIST
 06/31/2018 2017-2018

Page: 4
 BAR055
 Check # 00001000 - 99995183

Check	Date	Vendor#	Vendor Name	P.O.	F/P	Inv Date	Invoice #	Check Amount	Batch	Src	Stat
10-0101.002.000.00.00 Cash - PNC Bank											
10180987	06/29/18	ZZ31	Sun Life Assurance Co of Canada (U.S.)					\$11,574.40	20180698	CC	O
			EMPLOYEE - DISABILITY INSURANCE	047022 / 10-0470.022.000.00.00		06/22/18	PY-VD10-20180622M	2,914.74			
			EMPLOYEE - DISABILITY INSURANCE	047022 / 10-0470.022.000.00.00		06/08/18	PY-VD10-20180608M	8,659.66			
99995170	06/08/18	ZZ02	PA DEPT OF REVENUE					\$82,369.90	620	WT	O
			EMPLOYEE - State Tax - Pennsylvania	047014 / 10-0470.014.000.00.00		06/08/18	PY-ST-PA-20180608P	82,369.90			
99995171	06/08/18	ZZ07	PENNSYLVANIA SCDU					\$938.80	620	WT	O
			EMPLOYEE - GARNISHMENT - A FOR ALLEGHENY	047025 / 10-0470.025.000.00.00		06/08/18	PY-VD13A-20180608P	938.80			
99995172	06/08/18	ZZ01	PNC BANK PAYROLL					\$675,733.35	620	WT	O
			EMPLOYEE - Social Security	047011 / 10-0470.011.000.00.00		06/08/18	PY-SOSEC-20180608P	166,266.87			
			EMPLOYEE - Medicare	047011 / 10-0470.011.000.00.00		06/08/18	PY-MCARE-20180608P	38,885.10			
			EMPLOYEE - Federal Income Tax	047012 / 10-0470.012.000.00.00		06/08/18	PY-FIT-20180608P	265,429.41			
			EMPLOYER - Medicare	047529 / 10-0475.029.000.00.00		06/08/18	PY-MCARE-20180608P	38,885.10			
			EMPLOYER - Social Security	047529 / 10-0475.029.000.00.00		06/08/18	PY-SOSEC-20180608P	166,266.87			
99995173	06/08/18	ZZ01	PNC BANK PAYROLL					\$16,962.52	620	WT	O
			EMPLOYEE - NET PAY NOT DEPOSITED	047070 / 10-0470.070.000.00.00		06/08/18	PY-NET-20180608P	16,962.52			
99995174	06/08/18	ZZDD	SHALER AREA SCHOOL DIST					\$1,685,201.84	620	WT	O
			EMPLOYEE - Direct Deposit Net	047070 / 10-0470.070.000.00.00		06/08/18	PY-DDN-20180608P	1,669,006.84			
			EMPLOYEE - Direct Deposit Fixed	047070 / 10-0470.070.000.00.00		06/08/18	PY-DDF-20180608P	16,195.00			
99995175	06/22/18	ZZ02	PA DEPT OF REVENUE					\$31,728.20	620	WT	O
			EMPLOYEE - State Tax - Pennsylvania	047014 / 10-0470.014.000.00.00		06/22/18	PY-ST-PA-20180622P	31,728.20			
99995176	06/22/18	ZZ07	PENNSYLVANIA SCDU					\$938.80	620	WT	O
			EMPLOYEE - GARNISHMENT - A FOR ALLEGHENY	047025 / 10-0470.025.000.00.00		06/22/18	PY-VD13A-20180622P	938.80			
99995177	06/22/18	ZZ01	PNC BANK PAYROLL					\$262,980.55	620	WT	O
			EMPLOYEE - Social Security	047011 / 10-0470.011.000.00.00		06/22/18	PY-SOSEC-20180622P	63,906.58			

Date: 07/02/18

Time: 09:46:05

Check Dates 07/12/02 - 06/29/18

Shaler Area School District

SUPPLEMENT C.1A CHECK LIST

06/31/2018 2017-2018

Page: 5

BAR055

Check # 00001000 - 99995183

Check	Date	Vendor#	Vendor Name	P.O.	F/P	Inv Date	Invoice #	Check Amount	Batch	Src	Stat
10-0101.002.000.00.00 Cash - PNC Bank											
99995177	06/22/18	ZZ01	PNC BANK PAYROLL					\$262,980.55	620	WT	O
			EMPLOYEE - Medicare	047011 / 10-0470.011.000.00.00		06/22/18	PY-MCARE-20180622P	14,945.99			
			EMPLOYEE - Federal Income Tax	047012 / 10-0470.012.000.00.00		06/22/18	PY-FIT-20180622P	105,275.41			
			EMPLOYER - Social Security	047529 / 10-0475.029.000.00.00		06/22/18	PY-SOSEC-20180622P	63,906.58			
			EMPLOYER - Medicare	047529 / 10-0475.029.000.00.00		06/22/18	PY-MCARE-20180622P	14,945.99			
99995178	06/22/18	ZZ01	PNC BANK PAYROLL					\$2,180.74	620	WT	O
			EMPLOYEE - NET PAY NOT DIRECT DEPOSITED	047070 / 10-0470.070.000.00.00		06/22/18	PY-NET-20180622P	2,180.74			
99995179	06/22/18	ZZDD	SHALER AREA SCHOOL DIST					\$670,608.57	620	WT	O
			EMPLOYEE - Direct Deposit Fixed	047070 / 10-0470.070.000.00.00		06/22/18	PY-DDF-20180622P	10,055.00			
			EMPLOYEE - Direct Deposit Net	047070 / 10-0470.070.000.00.00		06/22/18	PY-DDN-20180622P	660,553.57			
99995180	06/21/18	ZZ13	PUBLIC SCHOOL EMPLOYES' RETIREMENT					\$3,058,794.62	20180695	WT	O
			EMPLOYER - Retirement 10.3%	047531 / 10-0475.031.000.00.00		03/30/18	PY-RTF10-201803300	8,997.47			
			EMPLOYER - Retirement 6.25%	047531 / 10-0475.031.000.00.00		03/02/18	PY-RTC6-201803020	934.46			
			EMPLOYER - Retirement 6.25%	047531 / 10-0475.031.000.00.00		02/16/18	PY-RTC6-201802160	947.03			
			EMPLOYER - Retirement 6.25%	047531 / 10-0475.031.000.00.00		03/30/18	PY-RTC6-201803300	934.46			
			EMPLOYER - Retirement 6.25%	047531 / 10-0475.031.000.00.00		03/16/18	PY-RTC6-201803160	934.46			
			EMPLOYER - Retirement 10.3%	047531 / 10-0475.031.000.00.00		02/02/18	PY-RTF10-201802020	8,564.13			
			EMPLOYER - Retirement 6.50%	047531 / 10-0475.031.000.00.00		01/05/18	PY-RTD6-201801050	3,957.23			
			EMPLOYER - Retirement 6.25%	047531 / 10-0475.031.000.00.00		01/19/18	PY-RTC6-201801190	935.16			
			EMPLOYER - Retirement 6.25%	047531 / 10-0475.031.000.00.00		02/02/18	PY-RTC6-201802020	934.46			
			EMPLOYER - Retirement Sabbatical 7.50%	047531 / 10-0475.031.000.00.00		03/02/18	PY-RSD7-201803020	748.66			
			EMPLOYER - Retirement Sabbatical 7.50%	047531 / 10-0475.031.000.00.00		02/02/18	PY-RSD7-201802020	748.66			
			EMPLOYER - Retirement Sabbatical 7.50%	047531 / 10-0475.031.000.00.00		03/16/18	PY-RSD7-201803160	748.66			
			EMPLOYER - Retirement 10.3%	047531 / 10-0475.031.000.00.00		03/02/18	PY-RTF10-201803020	9,110.39			
			EMPLOYER - Retirement 10.3%	047531 / 10-0475.031.000.00.00		02/16/18	PY-RTF10-201802160	11,534.65			
			EMPLOYER - Retirement 6.25%	047531 / 10-0475.031.000.00.00		01/05/18	PY-RTC6-201801050	934.46			

Date: 07/02/18

Time: 09:46:05

Check Dates 07/12/02 - 06/29/18

Shaler Area School District

SUPPLEMENT C.1A CHECK LIST

06/31/2018 2017-2018

Page: 6

BAR055

Check # 00001000 - 99995183

Check	Date	Vendor#	Vendor Name	P.O.	F/P	Inv Date	Invoice #	Check Amount	Batch	Src	Stat
10-0101.002.000.00.00 Cash - PNC Bank											
99995180	06/21/18	2213	PUBLIC SCHOOL EMPLOYES' RETIREMENT					\$3,058,794.62	20180695	WT	0
			EMPLOYER - Retirement 10.3%	047531	/	10-0475.031.000.00.00	01/19/18 PY-RTF10-201801190	8,169.15			
			EMPLOYER - Retirement Sabbatical 7.50%	047531	/	10-0475.031.000.00.00	03/30/18 PY-RSD7-201803300	748.66			
			EMPLOYER - Retirement 6.50%	047531	/	10-0475.031.000.00.00	01/19/18 PY-RTD6-201801190	4,695.61			
			EMPLOYER - Retirement 7.5% (post 7/1/11)	047531	/	10-0475.031.000.00.00	03/16/18 PY-RTE7-201803160	27,810.75			
			EMPLOYER - Retirement 7.50%	047531	/	10-0475.031.000.00.00	03/30/18 PY-RTD7-201803300	390,880.06			
			EMPLOYER - Retirement 7.5% (post 7/1/11)	047531	/	10-0475.031.000.00.00	03/02/18 PY-RTE7-201803020	25,561.76			
			EMPLOYER - Retirement 7.50%	047531	/	10-0475.031.000.00.00	03/16/18 PY-RTD7-201803160	419,170.65			
			EMPLOYER - Retirement 7.5% (post 7/1/11)	047531	/	10-0475.031.000.00.00	01/19/18 PY-RTE7-201801190	23,021.28			
			EMPLOYER - Retirement 7.5% (post 7/1/11)	047531	/	10-0475.031.000.00.00	02/16/18 PY-RTE7-201802160	33,279.74			
			EMPLOYER - Retirement 7.5% (post 7/1/11)	047531	/	10-0475.031.000.00.00	01/05/18 PY-RTE7-201801050	22,696.92			
			EMPLOYER - Retirement 7.50%	047531	/	10-0475.031.000.00.00	03/02/18 PY-RTD7-201803020	385,935.95			
			EMPLOYER - Retirement 7.5% (post 7/1/11)	047531	/	10-0475.031.000.00.00	03/30/18 PY-RTE7-201803300	27,732.50			
			EMPLOYER - Retirement 6.50%	047531	/	10-0475.031.000.00.00	03/02/18 PY-RTD6-201803020	4,052.34			
			EMPLOYER - Retirement 6.50%	047531	/	10-0475.031.000.00.00	03/16/18 PY-RTD6-201803160	4,393.60			
			EMPLOYER - Retirement 6.50%	047531	/	10-0475.031.000.00.00	02/16/18 PY-RTD6-201802160	4,217.81			
			EMPLOYER - Retirement 6.50%	047531	/	10-0475.031.000.00.00	03/30/18 PY-RTD6-201803300	4,291.25			
			EMPLOYER - Retirement 6.50%	047531	/	10-0475.031.000.00.00	02/02/18 PY-RTD6-201802020	3,981.78			
			EMPLOYER - Retirement 7.50%	047531	/	10-0475.031.000.00.00	01/19/18 PY-RTD7-201801190	397,910.84			
			EMPLOYER - Retirement 7.50%	047531	/	10-0475.031.000.00.00	01/05/18 PY-RTD7-201801050	374,079.86			
			EMPLOYER - Retirement 10.3%	047531	/	10-0475.031.000.00.00	01/05/18 PY-RTF10-201801050	7,918.19			
			EMPLOYER - Retirement 7.50%	047531	/	10-0475.031.000.00.00	02/16/18 PY-RTD7-201802160	412,784.18			
			EMPLOYER - Retirement 7.50%	047531	/	10-0475.031.000.00.00	02/02/18 PY-RTD7-201802020	386,235.80			
			EMPLOYER - Retirement Sabbatical 7.50%	047531	/	10-0475.031.000.00.00	02/16/18 PY-RSD7-201802160	748.66			

Date: 07/02/18

Time: 09:46:06

Check Dates 07/12/02 - 06/29/18

Shaler Area School District

SUPPLEMENT C.1A CHECK LIST

06/31/2018 2017-2018

Page: 7

BAR055

Check # 00001000 - 99995183

Check	Date	Vendor#	Vendor Name	P.O.	F/P	Inv Date	Invoice #	Check Amount	Batch	Src	Stat
10-0101.002.000.00.00 Cash - PNC Bank											
99995180	06/21/18	Z213	PUBLIC SCHOOL EMPLOYEES' RETIREMENT					\$3,058,794.62	20180695	WT	O
			EMPLOYER - Retirement 7.5% (post 7/1/11)	047531 / 10-0475.031.000.00.00		02/02/18	PY-RTE7-201802020	26,373.03			
			EMPLOYER - Retirement 10.3%	047531 / 10-0475.031.000.00.00		03/16/18	PY-RTF10-201803160	9,642.59			
			EMPLOYER - Retirement Sabbatical 7.50%	047531 / 10-0475.031.000.00.00		01/19/18	PY-RSD7-201801190	748.66			
			EMPLOYER - Retirement Sabbatical 7.50%	047531 / 10-0475.031.000.00.00		01/05/18	PY-RSD7-201801050	748.66			
99995182	06/29/18	Z213	PUBLIC SCHOOL EMPLOYEES' RETIREMENT					\$281,410.87	20180698	WT	O
			EMPLOYEE - Retirement Sabbatical 7.50%	04709 / 10-0470.009.000.00.00		06/22/18	PY-RSD7-20180622M	94.53			
			EMPLOYEE - Retirement 6.25%	04709 / 10-0470.009.000.00.00		06/08/18	PY-RTC6-20180608M	199.47			
			EMPLOYEE - Retirement Sabbatical 7.50%	04709 / 10-0470.009.000.00.00		06/08/18	PY-RSD7-20180608M	656.38			
			EMPLOYEE - Retirement 6.25%	04709 / 10-0470.009.000.00.00		06/22/18	PY-RTC6-20180622M	188.72			
			EMPLOYEE - Retirement 6.50%	04709 / 10-0470.009.000.00.00		06/08/18	PY-RTD6-20180608M	3,411.51			
			EMPLOYEE - Retirement 10.3%	04709 / 10-0470.009.000.00.00		06/08/18	PY-RTF10-20180608M	3,111.05			
			EMPLOYEE - Retirement 10.3%	04709 / 10-0470.009.000.00.00		06/22/18	PY-RTF10-20180622M	2,343.46			
			EMPLOYEE - Retirement 7.5% (post 7/1/11)	04709 / 10-0470.009.000.00.00		06/22/18	PY-RTE7-20180622M	3,992.38			
			EMPLOYEE - Retirement 7.50%	04709 / 10-0470.009.000.00.00		06/22/18	PY-RTD7-20180622M	70,262.91			
			EMPLOYEE - Retirement 7.5% (post 7/1/11)	04709 / 10-0470.009.000.00.00		06/08/18	PY-RTE7-20180608M	6,466.70			
			EMPLOYEE - Retirement 6.50%	04709 / 10-0470.009.000.00.00		06/22/18	PY-RTD6-20180622M	396.17			
			EMPLOYEE - Retirement 7.50%	04709 / 10-0470.009.000.00.00		06/08/18	PY-RTD7-20180608M	190,287.59			
99995183	06/29/18	Z214	PUBLIC SCHOOL EMPL RETIREMENT SYS					\$431.79	20180698	WT	O
			EMPLOYEE - BUYBACK RETIREMENT	047024 / 10-0470.024.000.00.00		06/22/18	PY-VD12-20180622M	213.49			
			EMPLOYEE - BUYBACK RETIREMENT	047024 / 10-0470.024.000.00.00		06/08/18	PY-VD12-20180608M	218.30			

Date: 07/02/18

Time: 09:46:06

Check Dates 07/12/02 - 06/29/18

Shaler Area School District

SUPPLEMENT C.1A CHECK LIST

06/31/2018 2017-2018

Page: 8

BAR055

Check # 00001000 - 99995183

Check	Date	Vendor#	Vendor Name	P.O.	F/P	Inv Date	Invoice #	Check Amount	Batch	Src Stat
-------	------	---------	-------------	------	-----	----------	-----------	--------------	-------	----------

Totals For Bank Account 10-0101.002.000.00.00 Cash - PNC Bank

	Total	Count		Total	Count
Computer Check	243,302.43	16	Outstanding	7,013,582.98	29
Hand Check	0.00	0	Reconciled	0.00	0
Wire Transfer	6,770,280.55	13	Stop Payment	0.00	0
			Voids	0.00	0

Date: 07/17/18
 Time: 15:58:30

Shaler Area School District
 ADDENDUM C.1A 7-18-18 2018-2019

Page: 1
 BAR046i

Account Number	Description	Amount
APP06 APPLE, INC		
10-5110.831.222.00.00/5110831222	Debt - Prior Yr Refunds - Interest-loan/lease Agr	\$384.70
10-5110.911.222.00.00/5110911222	Debt - Prior Yr Refunds - Lease Pmts/principle	\$48,483.18
	Vendor Total	\$48,867.88
12BA AMY BODENLOS		
10-2380.584.000.19.00/000000001679	mileage	\$100.12
CIT21 EDSYS INC-CITY CHARTER HIGH SCHOOL		
10-1110.562.000.31.00/1156231	SL - BALANCE DUE THROUGH MAY 2018	\$4,729.21
A*9960 JUDY DIETZ		
ESTATE OF JUDITY A DIETZ		
10-0155.213.000.00.00/0155213	REIMBURSEMENT OF 8/2018 - 6/2019 SUP LIFE INSURANCE PREMIUM	\$217.80
ERB01 DENNIS ERB (HS)		
DENISE ERB		
10-2310.820.000.00.00/2310820	REPLACE GLASSES BROKEN DURING CONDUCT OF SCHOOL PROGRAM	\$219.94
ESC88 eSchoolView		
10-2818.618.000.00.00/2818618	SOFTWARE SUPPLIES & LICENSING	\$5,784.00
ETN01 BOROUGH OF ETNA		
10-2790.330.000.00.00/2790330	DISTRICT'S SHARE FOR CROSSING GUARDS 9/17 - 6/18	\$20,626.98
FOR02 FORECAST5 ANALYTICS		
FORECAST5 ANALYTICS, INC		
10-2818.618.000.00.00/2818618	SOFTWARE SUPPLIES & LICENSING	\$15,500.00
HEI01 LINDA HEINAUER		
LINDA HEINAUER		
10-2140.584.000.30.00/214058430	MILEAGE - JANUARY THROUGH JUNE 2018	\$348.31
HOR01 HORIZON SOFTWARE INTERNATIONAL, LLC		
10-2818.618.000.00.00/2818618	SOFTWARE SUPPLIES & LICENSING	\$225.00
10-2818.618.000.00.00/2818618	SOFTWARE SUPPLIES & LICENSING	\$975.00
	Vendor Total	\$1,200.00
MCG52 MCGRAW-HILL EDUCATION, INC.		
MCGRAW-HILL SCHOOL EDUCATION HOLD		
10-1110.640.000.35.15/6403515	BOOKS	\$5,528.25
PEN21 PA MUNICIPAL SVC CO		
10-2334.332.000.00.00/2334332	Del Real Estate Tax - Deliquent	\$210.80
10-2334.332.000.00.00/2334332	Del Real Estate Tax - Deliquent	\$382.83
	Vendor Total	\$593.63
PIT41 PITTSBURGH POST-GAZETTE		
10-2519.549.000.00.00/2510540	PROPOSED FINAL - ADVERTISING	\$601.75
PRO66 PROVIDENT CHARTER SCHOOL		
10-1110.562.000.10.00/1156210	MAY 2018 - EL & AM	\$3,173.05
10-1110.562.000.10.00/1156210	APRIL 2018 - EL & AM	\$3,173.05
	Vendor Total	\$6,346.10

Date: 07/17/18
Time: 15:58:31

Shaler Area School District
ADDENDUM C.1A 7-18-18 2018-2019

Page: 2
BAR046i

Account Number	Description	Amount
RES06 RESERVE TOWNSHIP		
10-2790.330.000.00.00/2790330	DISTRICT PORTION OF CROSSING GUARDFOR APRIL, MAY AND JUNE 20	\$1,552.39
SHA11 TOWNSHIP OF SHALER		
10-2620.422.000.19.00/262042219	PERIOD ENDING JUNE 2018	\$80.55
10-2790.330.000.00.00/2790330	SEPTEMBER 2017 - JUNE 2018 - EDUCATIONAL SERVICE AGENCY	\$24,983.05
	Vendor Total	\$25,063.60
TRI17 TRI-COG LAND BANK		
10-2390.330.000.00.00/2390330	PAYMENT 1 OF 3	\$6,653.43
UPM01 UPMC HEALTH PLAN INS. WORKERS COMP		
UPMC HEALTH BENEFITS, INC.		
10-0475.032.000.00.00/047532	POLICY #WC100-0006183-2018A	\$287,085.00
	Report Total	\$431,018.39

Account Number	Amount	Vendor	Invoice Number	Date
10-2620.621.000.11.00	\$ 49.78	Direct Energy/Burchfield	AME75 HS8660262	6/30/2018
10-2620.621.000.19.00	\$ 2,071.48	Direct Energy/Elementary School	AME75 HS8660262	6/30/2018
10-2620.621.000.31.00	\$ 3,136.08	Direct Energy/High School	AME75 HS8660262	6/30/2018
10-2620.621.000.12.00	\$ 382.94	Direct Energy/Jeffery	AME75 HS8660262	6/30/2018
10-2620.621.000.13.00	\$ 429.19	Direct Energy/Marzolf	AME75 HS8660262	6/30/2018
10-2620.621.000.35.00	\$ 1,262.42	Direct Energy/Middle School	AME75 HS8660262	6/30/2018
10-2620.422.000.31.00	\$ 470.05	Duquesne Light/Anderson Rd Fid	DUQ02 3287310000 June 18	6/30/2018
10-2620.422.000.13.00	\$ 2,869.75	Duquesne Light/Marzolf School	DUQ02 1594070000 June 18	6/30/2018
10-2620.422.000.31.00	\$ 456.66	Duquesne Light/Townview St	DUQ02 8270640000 June 18	6/30/2018
10-2620.422.000.19.00	\$ 16,072.04	Duquesne Light/Elementary School	DUQ02 8993100000 June 18	6/30/2018
10-2620.422.000.19.00	\$ 36.93	Duquesne Light/Elementary School	DUQ02 5142260000 June 18	6/30/2018
10-2620.422.000.19.00	\$ 30.45	Duquesne Light/Elementary School	DUQ02 7193100000 June 18	6/30/2018
10-2620.422.000.31.00	\$ 27,728.23	Duquesne Light/High School	DUQ02 X347850000 June 18	6/30/2018
10-2620.422.000.35.00	\$ 14,555.38	Duquesne Light/Middle School	DUQ02 X830740000 June 18	6/30/2018
10-2620.422.000.35.00	\$ 1,969.85	Duquesne Light/Middle School	DUQ02 5813230000 June 18	6/30/2018
10-2620.422.000.12.00	\$ 64.15	Duquesne Light/Jeffery	DUQ02 1741420000 June 18	6/30/2018
10-2620.422.000.01.00	\$ 48.82	Duquesne Light/B&G	DUQ02 8967430000 June 18	6/30/2018
10-2620.422.000.01.00	\$ 402.23	Duquesne Light/B&G	DUQ02 9497700000 June 18	6/30/2018
10-2620.422.000.14.00	\$ 55.69	Duquesne Light/Reserve	DUQ02 1402760000 June 18	6/30/2018
10-2620.422.000.12.00	\$ 1,273.10	Duquesne Light/Jeffery	DUQ02 4611130000 June 18	6/30/2018
10-2620.422.000.13.00	\$ 142.48	Duquesne Light/Rogers	DUQ02 3421511700 June 18	6/30/2018
10-2650.626.000.00.00	\$ 2,966.39	Fleet Services	FLE21 54543574	6/30/2018
10-2620.424.000.31.00	\$ 7,397.18	Hampton/Shaler Water	HAM55 0115521320 June 18	6/30/2018
10-2620.424.000.35.00	\$ 4,144.15	Hampton/Shaler Water	HAM55 0115523668 June 18	6/30/2018
10-2620.424.000.35.00	\$ 119.70	Hampton/Shaler Water	HAM55 0115517958 June 18	6/30/2018
10-2620.424.000.13.00	\$ 1,977.87	Hampton/Shaler Water	HAM55 0115518052 June 18	6/30/2018
10-2620.424.000.12.00	\$ 1,149.76	Hampton/Shaler Water	HAM55 0115509582 June 18	6/30/2018
10-2620.424.000.31.00	\$ 322.16	Hampton/Shaler Water	HAM55 0115524454 June 18	6/30/2018
10-2620.424.000.31.00	\$ 138.60	Hampton/Shaler Water	HAM55 0115524394 June 18	6/30/2018
10-2620.424.000.31.00	\$ 141.44	Hampton/Shaler Water	HAM55 0115523886 June 18	6/30/2018
10-2620.424.000.31.00	\$ 99.70	Hampton/Shaler Water	HAM55 0115524964 June 18	6/30/2018
10-2611.442.000.00.00	\$ 32.28	Laurel Capital/B&G	LAU01 June 2018	6/30/2018
10-2380.442.000.11.00	\$ 140.48	Laurel Capital/Burchfield	LAU01 June 2018	6/30/2018

Account Number	Amount	Vendor	Invoice Number	Date
10-2519.442.000.00.00	\$ 106.39	Laurel Capital/Central	LAU01 June 2018	6/30/2018
10-2380.442.000.19.00	\$ 172.76	Laurel Capital/Elementary	LAU01 June 2018	6/30/2018
10-3249.442.000.31.00	\$ 32.29	Laurel Capital/High School	LAU01 June 2018	6/30/2018
10-2380.442.000.31.00	\$ 520.37	Laurel Capital/High School	LAU01 June 2018	6/30/2018
10-2380.442.000.12.00	\$ 127.95	Laurel Capital/Jeffery	LAU01 June 2018	6/30/2018
10-2380.442.000.13.00	\$ 140.48	Laurel Capital/Marzolf	LAU01 June 2018	6/30/2018
10-2380.442.000.35.00	\$ 255.90	Laurel Capital/Middle	LAU01 June 2018	6/30/2018
10-2380.442.000.14.00	\$ 127.95	Laurel Capital/Reserve	LAU01 June 2018	6/30/2018
10-2380.442.000.15.00	\$ 127.95	Laurel Capital/Rogers	LAU01 June 2018	6/30/2018
10-2620.621.000.13.00	\$ 93.64	Peoples Natural Gas/Marzolf	PEO02 200003959182 June 18	6/30/2018
10-2620.621.000.31.00	\$ 1,779.79	Peoples Natural Gas/High School	PEO02 200003958978 June 18	6/30/2018
10-2620.621.000.12.00	\$ 120.56	Peoples Natural Gas/Jeffery	PEO02 200003959083 June 18	6/30/2018
10-2620.621.000.19.00	\$ 326.17	Peoples Natural Gas/Elementary School	PEO02 200003959042 June 18	6/30/2018
10-2620.621.000.35.00	\$ 504.25	Peoples Natural Gas/Middle School	PEO02 200006921627 June 18	6/30/2018
10-2620.621.000.35.00	\$ 291.53	Peoples Natural Gas/Middle School	PEO02 200003958861 June 18	6/30/2018
10-5240.930.000.00.00	\$17,043.80	PNC	PNC02 Jun-18	6/30/2018
10-2540.442.000.00.00	\$ 6,895.00	ComDoc	COM05 5004649623	6/30/2018
10-0475.033.000.00.00	\$ 687,703.77	Allegheny County School Health Con.	ACS01 July Benefits	6/30/2018
10-0475.036.000.00.00	\$ 39,366.54	Allegheny County School Health Con.	ACS01 July Benefits	6/30/2018
10-0475.034.000.00.00	\$ 5,023.12	Allegheny County School Health Con.	ACS01 July Benefits	6/30/2018
10-2620.538.000.00.00	\$ 197.55	Verizonwireless	VER02 9807154120	6/30/2018
10-2360.530.000.00.37	\$ 10,000.00	Neopost	NEO01 Jun-18	6/30/2018
Total	\$ 863,095.17			

Date: 07/12/18
 Time: 15:40:44

Shaler Area School District
 SUPPLEMENT C.1A 7-18-2018
 2018-2019

Page: 1
 BAR046i

Account Number	Description	Amount
ABC21 ABC GLASS & MIRROR, LLC		
10-2620.610.000.31.00/262061031	MAINT - GEN SUP - HS	\$178.22
AG54 AG iREPAIR		
ASSETGENIE, INC		
10-1110.438.000.14.00/1143814	MAINT&REPAIR INFOR TECH EQ/INFRA - RESERVE	\$237.00
10-1110.438.000.31.00/1143831	MAINT&REPAIR INFOR TECH EQ/INFRA - HIGH SCHOOL	\$79.00
10-1110.438.000.31.00/1143831	MAINT&REPAIR INFOR TECH EQ/INFRA - HIGH SCHOOL	\$119.00
10-1110.438.000.31.00/1143831	MAINT&REPAIR INFOR TECH EQ/INFRA - HIGH SCHOOL	\$554.00
10-1110.438.000.31.00/1143831	MAINT&REPAIR INFOR TECH EQ/INFRA - HIGH SCHOOL	\$258.00
10-1110.438.000.31.00/1143831	MAINT&REPAIR INFOR TECH EQ/INFRA - HIGH SCHOOL	\$238.00
10-1110.438.000.35.00/1143835	MAINT&REPAIR INFOR TECH EQ/INFRA - MIDDLE SCHOOL	\$395.00
10-1110.438.000.35.00/1143835	MAINT&REPAIR INFOR TECH EQ/INFRA - MIDDLE SCHOOL	\$475.00
10-1110.618.000.31.00/1161831	INSTRUCTIONAL - SOFTWARE SUP & LICENSING - HIGH SCHOOL	\$18,585.00
10-1110.618.000.35.00/1161835	SOFTWARE SUPPLIES & LICENSING - MIDDLE SCHOOL	\$18,585.00
	Vendor Total	\$39,525.00
SA39 SEAN AIKEN		
10-2360.584.000.00.00/2360584	NOVEMBER 2017 THROUGH JUNE 2018 - MILEAGE	\$289.30
10-2620.538.000.00.00/2620538	NOVEMBER 2017 THROUGH JUNE 2018 - CELL PHONE	\$240.00
	Vendor Total	\$529.30
AIU00 ALLEGHENY INTERMED. UNIT		
ALLEGHENY INTERMEDIATE UNIT		
10-1110.562.000.31.00/1156231	4TH QUARTER 2017-2018 SCHOOL YEAR	\$8,730.00
10-1260.322.000.10.00/126032210	PT/OT - JANUARY 2018	\$26,234.25
10-2271.324.000.35.00/227132435	READING ACHIEVEMENT CENTER - LISA YONEK	\$900.00
	Vendor Total	\$35,864.25
ALL19 ALLEGHENY ENGINEERING CO		
10-2620.610.000.35.00/262061035	MAINT - GEN SUP - MS	\$291.14
ALW01 ALWAYS IN BLOOM		
10-2310.610.000.00.00/2310610	FUNERAL ARRANGE FOR MOTHER OF DR RUTH MODZELEWSKI (PRESIDENT)	\$57.50
AMA12 AMAZON.COM		
10-1241.750.000.10.00/124175010	ELEMENTARY - EQUIP-ORIGINAL & ADDL	\$59.99
10-1243.610.000.10.00/124361010	GIFTED - GENERAL SUPPLIES - ELEM	\$228.98
	Vendor Total	\$288.97
AMC22 AMCA SYSTEMS, LLC		
10-2519.330.000.00.00/2510330	RETIREE BILLING	\$51.00
10-2519.330.000.00.00/2510330	RETIREE BILLING	\$84.00
	Vendor Total	\$135.00
ALL43 APLS, INC		
10-2630.610.000.11.00/263061011	MAINT UP-KEEP - GENERAL SUPPLIES - BURCHFIELD	\$99.42
10-2630.610.000.11.00/263061011	MAINT UP-KEEP - GENERAL SUPPLIES - BURCHFIELD	\$132.56
10-2630.610.000.13.00/263061013	MAINT UP-KEEP - GENERAL SUPPLIES - MARZOLF	\$135.96
10-2630.610.000.31.00/263061031	MAINT UP-KEEP - GEN SUP - HS - MAT. FIELD	\$102.80
10-2630.610.000.31.00/263061031	MAINT UP-KEEP - GEN SUP - HS - MAT. FIELD	\$102.80
	Vendor Total	\$573.54
APP06 APPLE, INC		
10-1110.758.000.31.00/1175831	END-USER NEW EQ&LONG-TERM SOFTWARE - HS	\$299.00
10-5110.831.222.00.00/5110831222	Debt - Prior Yr Refunds - Interest-loan/lease Agr	\$2,345.34

Date: 07/12/18
 Time: 15:40:44

Shaler Area School District
 SUPPLEMENT C.1A 7-18-2018
 2018-2019

Page: 2
 BAR046i

Account Number	Description	Amount
APP06 APPLE, INC		
10-5110.911.222.00.00/5110911222	Debt - Prior Yr Refunds - Lease Pmts/principle	\$123,439.15
	Vendor Total	\$126,083.49
AQU01 AQUA CLEAN COMPANY INC		
10-2620.610.000.19.00/262061019	MAINT - GEN SUP - ELEM SCH	\$497.50
AZJ52 A-Z JANITORIAL SERVICES, LLC		
10-2620.610.000.01.23/6100123	MAINT - GEN SUP - B&G	\$61.14
10-2620.610.000.11.23/6101123	MAINT - GEN SUP - BURCHFIELD	\$369.54
10-2620.610.000.13.23/6101323	MAINT - GEN SUP - MARZOLF	\$257.65
10-2620.610.000.14.23/6101423	MAINT - GEN SUP - RESERVE	\$113.70
10-2620.610.000.15.23/6101523	MAINT - GEN SUP - ROGERS	\$1,925.06
10-2620.610.000.19.23/6101923	MAINT - GEN SUP - ELEM SCH	\$404.83
10-2620.610.000.31.23/6103123	MAINT - GEN SUP - HS	\$772.58
10-2620.610.000.35.23/6103523	MAINT - GEN SUP - MS	\$576.88
	Vendor Total	\$4,481.38
BAR02 B & R POOLS & SWIM SHOP		
10-2620.430.000.19.00/262043019	MAINT - REPAIRS - ELEM SCH	\$245.00
BH01 BETHANY BAKER		
10-2360.584.000.00.00/2360584	JANUARY THROUGH JUNE 2018 - MILEAGE	\$138.75
BAR23 FRED J BARTSCH GREENHOUSES, INC.		
JANE BARTSCH		
10-3228.610.000.00.00/3228610	HANGING BASKETS AND FERNS FOR GRADUATION	\$305.00
BAT21 BATTERIES PLUS		
BATTERIES PLUS PITTSBURGH		
10-2620.610.000.01.00/262061001	MAINT - GEN SUP - B&G	\$89.98
10-2620.610.000.13.00/262061013	MAINT - GEN SUP - MARZOLF	\$549.90
	Vendor Total	\$639.88
BRA54 BRADFORD AREA SCHOOL DISTRICT		
10-1232.568.000.31.00/123256831	AB - 4/5/18 - 4/30/18 CUSTER CITY PRIVATE SCHOOL	\$2,400.12
BRA34 BRANTNER GAIL ANN		
GAIL ANN BRANTNER		
10-5130.880.000.00.00/5130880	REFUND FOR TAX YEAR 2017	\$279.38
BUC22 BUCKEYE CLEANING CENTER-PITTSBURGH		
BUCKEYE CLEANING CENTERS		
10-2620.610.000.11.23/6101123	MAINT - GEN SUP - BURCHFIELD	\$2,560.80
10-2620.610.000.11.23/6101123	MAINT - GEN SUP - BURCHFIELD	\$180.00
10-2620.610.000.13.23/6101323	MAINT - GEN SUP - MARZOLF	\$2,615.70
10-2620.610.000.13.23/6101323	MAINT - GEN SUP - MARZOLF	\$120.00
10-2620.610.000.14.23/6101423	MAINT - GEN SUP - RESERVE	\$75.00
10-2620.610.000.14.23/6101423	MAINT - GEN SUP - RESERVE	\$788.00
10-2620.610.000.14.23/6101423	MAINT - GEN SUP - RESERVE	\$973.35
10-2620.610.000.14.23/6101423	MAINT - GEN SUP - RESERVE	\$109.56
10-2620.610.000.15.23/6101523	MAINT - GEN SUP - ROGERS	\$659.70
10-2620.610.000.15.23/6101523	MAINT - GEN SUP - ROGERS	\$75.00
10-2620.610.000.19.23/6101923	MAINT - GEN SUP - ELEM SCH	\$150.00
10-2620.610.000.19.23/6101923	MAINT - GEN SUP - ELEM SCH	\$439.80
10-2620.610.000.19.23/6101923	MAINT - GEN SUP - ELEM SCH	\$2,433.99
10-2620.610.000.31.23/6103123	MAINT - GEN SUP - HS	\$150.00
10-2620.610.000.35.23/6103523	MAINT - GEN SUP - MS	\$1,647.20

Date: 07/12/18
 Time: 15:40:44

Shaler Area School District
 SUPPLEMENT C.1A 7-18-2018
 2018-2019

Page: 3
 BAR046i

Account Number	Description	Amount
BUC22 BUCKEYE CLEANING CENTER-PITTSBURGH		
BUCKEYE CLEANING CENTERS		
10-2620.610.000.35.23/6103523	MAINT - GEN SUP - MS	\$659.70
10-2620.610.000.35.23/6103523	MAINT - GEN SUP - MS	\$813.00
10-2620.610.000.35.23/6103523	MAINT - GEN SUP - MS	\$225.00
10-2620.610.000.35.23/6103523	MAINT - GEN SUP - MS	\$438.24
Vendor Total		\$15,114.04
BUI09 BUILDERS HARDWARE		
10-2620.610.000.14.00/262061014	MAINT - GEN SUP - RESERVE	\$93.38
10-2620.610.000.19.00/262061019	MAINT - GEN SUP - ELEM SCH	\$90.93
10-2620.610.000.31.00/262061031	MAINT - GEN SUP - HS	\$365.30
10-2620.610.000.31.00/262061031	MAINT - GEN SUP - HS	\$273.44
10-2620.610.000.31.00/262061031	MAINT - GEN SUP - HS	\$394.52
Vendor Total		\$1,217.57
CAP52 CAPITAL TECHNOLOGIES		
CAPITAL TECHNOLOGIES, INC.		
10-2620.430.000.11.00/262043011	MAINT - REPAIRS - BURCHFIELD	\$29.17
10-2620.430.000.13.00/262043013	MAINT - REPAIRS- MARZOLF	\$29.17
10-2620.430.000.14.00/262043014	MAINT - REPAIRS - RESERVE	\$29.17
10-2620.430.000.19.00/262043019	MAINT - REPAIRS - ELEM SCH	\$29.17
10-2620.430.000.31.00/262043031	MAINT - REPAIRS - HS	\$254.15
10-2620.430.000.35.00/262043035	MAINT - REPAIRS - MIDDLE SCHOOL	\$29.17
Vendor Total		\$400.00
CEN13 CENTRAL POLY CORP		
10-2620.610.000.01.23/6100123	MAINT - GEN SUP - B&G	\$576.00
10-2620.610.000.11.23/6101123	MAINT - GEN SUP - BURCHFIELD	\$481.00
10-2620.610.000.13.23/6101323	MAINT - GEN SUP - MARZOLF	\$584.00
10-2620.610.000.14.23/6101423	MAINT - GEN SUP - RESERVE	\$265.40
10-2620.610.000.15.23/6101523	MAINT - GEN SUP - ROGERS	\$1,194.00
10-2620.610.000.19.23/6101923	MAINT - GEN SUP - ELEM SCH	\$1,683.00
10-2620.610.000.31.23/6103123	MAINT - GEN SUP - HS	\$2,460.50
10-2620.610.000.35.23/6103523	MAINT - GEN SUP - MS	\$1,683.00
Vendor Total		\$8,926.90
CIN12 CINTAS CORP.		
CINTAS		
10-2620.430.000.11.23/4301123	MAINT - REPAIRS - BURCHFIELD	\$50.51
10-2620.430.000.19.23/4301923	MAINT - REPAIRS - ELEM SCHOOL	\$107.60
Vendor Total		\$158.11
COM05 COMDOC		
10-2519.442.000.00.00/2510442	BLACK INK OVRAGE FOR 6/1/18 TO 6/30/18	\$79.94
CON90 CONSOLIDATED COMMUNICATIONS		
CONSOLIDATED COMMUNICATIONS		
10-2620.538.000.01.00/262053801	6/16/18 - 7/15/18	\$214.58
10-2620.538.000.11.00/262053811	6/16/18 - 7/15/18	\$107.30
10-2620.538.000.12.00/262053812	6/16/18 - 7/15/18	\$107.30
10-2620.538.000.13.00/262053813	6/16/18 - 7/15/18	\$134.11
10-2620.538.000.14.00/262053814	6/16/18 - 7/15/18	\$61.22
10-2620.538.000.15.00/262053815	6/16/18 - 7/15/18	\$80.47
10-2620.538.000.31.00/262053831	6/16/18 - 7/15/18	\$579.95
10-2620.538.000.35.00/262053835	6/16/18 - 7/15/18	\$268.52

Date: 07/12/18
 Time: 15:40:45

Shaler Area School District
 SUPPLEMENT C.1A 7-18-2018
 2018-2019

Page: 4
 BAR046i

Account Number	Description	Amount
CON90 CONSOLIDATED COMMUNICATIONS		
CONSOLIDATED COMMUNICATIONS		
10-2620.538.000.35.00/262053835	6/16/18 - 7/15/18	\$406.38
10-2620.538.000.35.00/262053835	6/16/18 - 7/15/18	\$616.29
	Vendor Total	\$2,576.12
CRA05 CRAFTSMEN-ZIEGLER PRINTING		
10-2540.610.000.00.00/2540610	GENERAL SUPPLIES	\$752.40
CRI03 CRITCHLOW ENTERPRISES INC		
10-2630.430.000.31.00/263043031	GROUNDS UP-KEEP - MAINT - HIGH SCHOOL	\$556.29
SUN02 CROWN CASTLE		
SUNESYS, LLC		
10-2620.538.000.00.00/2620538	TRANSPORT/TELECOMMUNICATIONS	\$2,470.72
INF01 CUSTOM COMPUTER SPECIALISTS, INC.		
10-2818.581.000.00.00/2818581	System-wide Technology Svc - Travel	\$535.17
10-2818.581.000.00.00/2818581	System-wide Technology Svc - Travel	\$875.65
10-2818.581.000.00.00/2818581	System-wide Technology Svc - Travel	\$1,000.37
10-2818.618.000.00.00/2818618	SOFTWARE SUPPLIES & LICENSING	\$41,220.00
	Vendor Total	\$43,631.19
DAN06 DANIELS ELECTRIC		
10-2620.430.000.19.00/262043019	MAINT - REPAIRS - ELEM SCH	\$435.00
10-2620.610.000.11.00/262061011	MAINT - GEN SUP - BURCHFIELD	\$400.00
	Vendor Total	\$835.00
DEA06 DEAR JOHN INC.		
10-2620.442.000.31.00/262044231	RENTAL-EQUIP&VEHICLES	\$62.50
10-2620.610.000.35.00/262061035	MAINT - GEN SUP - MS	\$62.50
	Vendor Total	\$125.00
LD12 LEZLIE DELVECCHIO-MARKS		
10-2120.582.000.10.00/212058210	JANUARY - JUNE 2018 MILEAGE	\$40.28
DRE44 DIGITAL DREAM LABS		
10-1110.610.171.10.00/61017110	Instruction-Regular Program - ENGIN AIU	\$467.88
DUN30 DUNEGAN MICHAEL G & MARY E		
10-5130.880.000.00.00/5130880	REFUND FOR TAX YEAR 2017	\$225.88
DMG52 DYNAMIC MEASUREMENT GROUP		
10-1110.322.000.11.00/1132011	PURCH PROF/EDUC SVC	\$382.50
10-1110.322.000.12.00/1132012	PURCH PROF/EDUC SVC	\$180.00
10-1110.322.000.13.00/1132013	PURCH PROF/EDUC SVC	\$360.00
10-1110.322.000.14.00/1132014	PURCH PROF/EDUC SVC	\$157.50
10-1110.322.000.15.00/1132015	PURCH PROF/EDUC SVC	\$202.50
10-1110.322.000.19.00/1132019	PURCH PROF/EDUC SVC	\$967.50
	Vendor Total	\$2,250.00
EBS02 EBSCO INFORMATION SERVICES		
10-2250.610.000.13.00/225061013	MARZOLF - GENERAL SUPPLIES	\$227.48
10-2250.640.000.14.00/225064014	LIBRARY - BOOKS - RESERVE	\$227.48
	Vendor Total	\$454.96
ELT04 ELTECH SECURITY SYSTEMS INC		
10-2620.430.000.01.00/262043001	MAINT - REPAIRS - BUTLER PLK	\$75.00
10-2620.430.000.11.00/262043011	MAINT - REPAIRS - BURCHFIELD	\$75.00
10-2620.430.000.12.00/262043012	MAINT - REPAIRS - JEFFERY	\$75.00

Date: 07/12/18
 Time: 15:40:45

Shaler Area School District
 SUPPLEMENT C.1A 7-18-2018
 2018-2019

Page: 5
 BAR046i

Account Number	Description	Amount
ELT04 ELTECH SECURITY SYSTEMS INC		
10-2620.430.000.13.00/262043013	MAINT - REPAIRS- MARZOLF	\$75.00
10-2620.430.000.14.00/262043014	MAINT - REPAIRS - RESERVE	\$75.00
10-2620.430.000.19.00/262043019	MAINT - REPAIRS - ELEM SCH	\$75.00
10-2620.430.000.31.00/262043031	MAINT - REPAIRS - HS	\$90.00
10-2620.430.000.35.00/262043035	MAINT - REPAIRS - MIDDLE SCHOOL	\$165.00
	Vendor Total	\$705.00
ENT21 ENTERPRISE RENT-A-CAR		
ENTERPRISE RENT A CAR CO OF PGH LLC		
10-3284.510.000.00.00/3284510	Tennis - Boys & Girls - STUDENT TRANSPORT SVC	\$157.18
FIL21 FILTECH, INC.		
10-2620.610.000.13.00/262061013	MAINT - GEN SUP - MARZOLF	\$140.00
10-2620.610.000.19.00/262061019	MAINT - GEN SUP - ELEM SCH	\$454.00
	Vendor Total	\$594.00
FIR23 FIRST FIRE PROTECTION		
10-2620.430.000.01.00/262043001	MAINT - REPAIRS - BUTLER PLK	\$50.40
10-2620.430.000.11.00/262043011	MAINT - REPAIRS - BURCHFIELD	\$683.70
10-2620.430.000.13.00/262043013	MAINT - REPAIRS- MARZOLF	\$448.80
10-2620.430.000.14.00/262043014	MAINT - REPAIRS - RESERVE	\$410.40
10-2620.430.000.19.00/262043019	MAINT - REPAIRS - ELEM SCH	\$521.90
10-2620.430.000.31.00/262043031	MAINT - REPAIRS - HS	\$1,040.90
10-2620.430.000.35.00/262043035	MAINT - REPAIRS - MIDDLE SCHOOL	\$812.10
	Vendor Total	\$3,968.20
ZF31 ZACHERY FISHER		
10-1110.610.184.00.96/111061018496	REIMBURSEMENT FOR STEAM CAMP SUPPLIES - JIFFY SHIRTS	\$54.18
10-1110.610.184.00.96/111061018496	REIMBURSEMENT FOR STEAM CAMP SUPPLIES - JOHNSON PLASTICS	\$31.60
	Vendor Total	\$85.78
STR22 FIT OPTIMIZED SOLUTIONS		
10-2620.430.000.31.00/262043031	MAINT - REPAIRS - HS	\$1,087.20
FOU52 FOUNTAIN PRODUCTS		
10-2620.434.000.35.00/262043435	Operation/bldg Svc - MAINT. REPAIRS KITCHEN	\$2,790.00
10-2620.764.000.13.00/262076413	Operation/bldg Svc - Capital Equipment Food Service	\$2,500.00
	Vendor Total	\$5,290.00
FOX05 FOX CHAPEL GIRLS VOLLEYBALL		
10-3293.580.000.00.00/3293580	TOURNAMENT FEE - 2 TEAMS	\$400.00
FOX03 BRIAN FOX		
MR BRIAN FOX		
10-1110.618.000.35.00/1161835	REFUND FOR PAYMENT OF LOST IPAD THAT WAS FOUND (NF)	\$331.00
WAT04 THE WATSON INSTITUTE FRIENDSHIP ACADEMY		
FRIENDSHIP ACADEMY		
10-1231.568.000.30.00/123156830	DE - APRIL, MAY, JUNE 2018	\$11,694.54
10-1233.567.000.30.00/123356730	HT - APRIL, MAY, JUNE 2018	\$11,694.54
	Vendor Total	\$23,389.08

Date: 07/12/18

Time: 15:40:45

Shaler Area School District
SUPPLEMENT C.1A 7-18-2018
2018-2019

Page: 6

BAR046i

Account Number	Description	Amount
FRO21 FRONTLINE TECHNOLOGIES GROUP, LLC		
10-2839.330.000.00.00/2830330	PURCH OTHER PROF SVC	\$10,705.97
GEA05 NICOLE GEARY		
10-2271.581.000.15.00/227158115	"Get Your Teach On" National Conference - District Contribut	\$250.00
GER12 HARRY GERHARDT		
H GERHARDT SUPPLY		
10-2620.610.000.01.00/262061001	MAINT - GEN SUP - B&G	\$95.85
GER30 GERMANOS THOMAS		
10-5130.880.000.00.00/5130880	REFUND FOR TAX YEAR 2017	\$1,681.56
GLA21 GLADE RUN LUTHERAN SERVICES		
10-1260.322.000.30.00/126032230	JUNE 2018 OCCUP/PHS THERAPY TT	\$45.00
10-1260.322.000.30.00/126032230	MAY 2018 OCCUP/PHYS THERAPY DAY STUDENT - TT	\$105.30
10-1442.568.000.31.00/144256831	MAY/JUNE 2018 DAY STUDENT - DD	\$3,255.88
10-1442.568.000.31.00/144256831	MAY/JUNE 2018 DAY ENHANCED STUDENTS - JH & DY	\$7,329.01
10-1442.568.000.31.00/144256831	MAY/JUNE 2018 DAY AUTISM STUDENT - TT	\$4,333.33
	Vendor Total	\$15,068.52
GLO14 GLOBAL INDUSTRIES INC.		
GLOBAL EQUIPMENT COMPANY INC.		
10-2620.610.000.14.23/6101423	MAINT - GEN SUP - RESERVE	\$128.61
10-2620.610.000.19.23/6101923	MAINT - GEN SUP - ELEM SCH	\$128.60
	Vendor Total	\$257.21
GRA44 KATHLEEN GRACZYK		
10-1490.610.000.98.00/149061098	REIMBURSEMENT FOR ESY SUPPLIES	\$87.87
10-2111.580.000.10.00/211058010	JULY 2017 THROUGH JUNE 2018 MILEAGE	\$803.35
	Vendor Total	\$891.22
GRA66 GRADE POINT RESOURCES LLC		
10-1231.323.000.30.00/123132330	JULY 2018 INSTALLMENT - BEHAVIOR SPECIALISTS @ 122,000 PER Y	\$10,166.87
10-1290.322.000.10.98/12903221098	CONSULTATION - ESY MEETING 3.5 HRS @ \$70.	\$245.00
10-1290.322.000.10.98/12903221098	CONSULTATION: REINFORCERS (PRIZES) FOR ESY - 10 HRS @ \$70	\$700.00
	Vendor Total	\$11,111.87
GRA01 GRAINGER		
10-2620.610.000.01.23/6100123	MAINT - GEN SUP - B&G	\$124.92
10-2620.610.000.01.23/6100123	MAINT - GEN SUP - B&G	\$41.64
10-2620.610.000.19.00/262061019	MAINT - GEN SUP - ELEM SCH	\$239.58
10-2620.610.000.19.00/262061019	MAINT - GEN SUP - ELEM SCH	\$88.15
10-2620.610.000.35.00/262061035	MAINT - GEN SUP - MS	\$1,172.21
	Vendor Total	\$1,666.50
GRI01 E H GRIFFITH INC		
10-2620.610.000.12.23/6101223	MAINT - GEN SUP - JEFFERY	\$1,930.00
01LG LEEANN GUIDO		
10-2160.582.000.30.55/21605823055	MAY & JUNE TRAVEL EXPENSES	\$32.28
10-2271.581.000.31.00/227158131	PBS IMPLEMENTERS FORUM - HERSHEY, PA - MEALS	\$51.96
	Vendor Total	\$84.24

Date: 07/12/18
 Time: 15:40:45

Shaler Area School District
 SUPPLEMENT C.1A 7-18-2018
 2018-2019

Page: 7
 BAR0461

Account Number	Description	Amount
HAR44 HARRIS SCHOOL SOLUTIONS		
10-2818.618.000.00.00/2818618	SOFTWARE SUPPLIES & LICENSING	\$27,131.38
10-2818.618.000.00.00/2818618	SOFTWARE SUPPLIES & LICENSING	\$38,202.84
Vendor Total		\$65,334.22
HAS01 D HASTINGS CO INC		
10-2620.610.000.01.00/262061001	MAINT - GEN SUP - B&G	\$26.96
10-2620.610.000.01.00/262061001	MAINT - GEN SUP - B&G	\$13.99
10-2620.610.000.01.00/262061001	MAINT - GEN SUP - B&G	\$52.70
10-2620.610.000.11.00/262061011	MAINT - GEN SUP - BURCHFIELD	\$12.99
10-2620.610.000.19.00/262061019	MAINT - GEN SUP - ELEM SCH	\$24.99
10-2620.610.000.19.00/262061019	MAINT - GEN SUP - ELEM SCH	\$6.74
10-2620.610.000.31.00/262061031	MAINT - GEN SUP - HS	\$10.49
10-2620.610.000.31.00/262061031	MAINT - GEN SUP - HS	\$38.36
10-2620.610.000.31.00/262061031	MAINT - GEN SUP - HS	\$29.79
10-2620.610.000.35.00/262061035	MAINT - GEN SUP - MS	\$6.74
10-2620.610.000.35.00/262061035	MAINT - GEN SUP - MS	\$10.02
Vendor Total		\$233.77
HIT41 THE HITE CO		
10-2620.610.000.11.00/262061011	MAINT - GEN SUP - BURCHFIELD	\$388.07
10-2620.610.000.11.00/262061011	MAINT - GEN SUP - BURCHFIELD	\$12.02
10-2620.610.000.11.00/262061011	MAINT - GEN SUP - BURCHFIELD	\$777.77
10-2620.610.000.11.00/262061011	MAINT - GEN SUP - BURCHFIELD	\$36.05
10-2620.610.000.19.00/262061019	MAINT - GEN SUP - ELEM SCH	\$5.77
10-2620.610.000.31.00/262061031	MAINT - GEN SUP - HS	\$424.80
10-2620.610.000.35.00/262061035	MAINT - GEN SUP - MS	\$33.56
10-2620.610.000.35.00/262061035	MAINT - GEN SUP - MS	\$315.89
Vendor Total		\$1,993.93
HOM14 HOME DEPOT CREDIT SERVICES		
HOME DEPOT		
10-2620.610.000.01.00/262061001	MAINT - GEN SUP - B&G	\$-59.94
10-2620.610.000.01.00/262061001	MAINT - GEN SUP - B&G	\$88.03
10-2620.610.000.01.00/262061001	MAINT - GEN SUP - B&G	\$122.99
10-2620.610.000.01.00/262061001	MAINT - GEN SUP - B&G	\$66.61
10-2620.610.000.01.00/262061001	MAINT - GEN SUP - B&G	\$5.70
10-2620.610.000.14.00/262061014	MAINT - GEN SUP - RESERVE	\$136.58
10-2620.610.000.14.00/262061014	MAINT - GEN SUP - RESERVE	\$40.38
10-2620.610.000.19.00/262061019	MAINT - GEN SUP - ELEM SCH	\$50.62
10-2620.610.000.35.00/262061035	MAINT - GEN SUP - MS	\$26.94
Vendor Total		\$477.91
HOO30 HOOD JASON T & ASHLEY		
10-5130.880.000.00.00/5130880	REFUND FOR TAX YEAR 2017	\$273.79
HOR22 HORIZON INFORMATION SERVICES		
10-2620.430.000.31.00/262043031	MAINT - REPAIRS - HS	\$1,343.00
10-2620.430.000.35.00/262043035	MAINT - REPAIRS - MIDDLE SCHOOL	\$140.00
Vendor Total		\$1,483.00
SH01 SHANNON HOWARD		
10-2380.580.000.35.00/238058035	JANUARY - FEBRUARY 2018 TRAVEL EXPENSES	\$33.44

Date: 07/12/18
Time: 15:40:45

Shaler Area School District
SUPPLEMENT C.1A 7-18-2018
2018-2019

Page: 8
BAR0461

Account Number	Description	Amount
HUC54 HUCKESTEIN MECHANICAL SERVICE, INC.		
10-2620.430.000.35.00/262043035	MAINT - REPAIRS - MIDDLE SCHOOL	\$4,370.00
IMM02 IMMEL BICYCLE CENTER		
10-1110.430.000.31.08/114303108	REPAIRS/MAINT - HIGH SCHOOL PHY ED	\$500.00
JOH09 JOHNSTONBAUGH'S MUSIC CENTER		
10-1110.610.000.19.12/6101912	MIDDLE/ELEM - GENERAL SUPPLIES	\$552.06
10-1110.610.000.19.12/6101912	MIDDLE/ELEM - GENERAL SUPPLIES	\$215.81
	Vendor Total	\$767.87
JOH55 JOHNSTONE SUPPLY		
10-2620.610.000.19.00/262061019	MAINT - GEN SUP - ELEM SCH	\$129.05
10-2620.610.000.19.00/262061019	MAINT - GEN SUP - ELEM SCH	\$22.99
10-2620.610.000.35.00/262061035	MAINT - GEN SUP - MS	\$11.05
	Vendor Total	\$163.09
JOM30 JOMAN PROPERTIES LLC		
10-5130.880.000.00.00/5130880	REFUND FOR TAX YEAR 2017	\$1,215.32
JOS01 JOSTENS, INC.		
10-2360.610.000.00.00/2360610	GRADUATION GOWNS FOR DEPARTMENT CHAIRS	\$40.00
10-3228.610.000.00.00/3228610	Commencement - GENERAL SUPPLIES	\$14.74
	Vendor Total	\$54.74
JTT02 J&T TIRE CO INC		
J & T TIRE CO., INC		
10-2650.433.000.00.00/2650433	Vehicle Oper & Maint - Repairs & Maintenance Srvcs Veh1	\$1,027.64
10-2650.433.000.00.00/2650433	Vehicle Oper & Maint - Repairs & Maintenance Srvcs Veh1	\$44.20
	Vendor Total	\$1,071.84
JK01 JOHN KAIB		
10-2611.584.000.00.00/2611584	MILEAGE - JUNE 2018	\$190.80
CK12 CARI KELM		
10-1110.610.184.00.96/111061018496	REIMBURSEMENT FOR SUPPLIES	\$579.24
KNI05 KNIGHT SOUND & LIGHTING		
10-2620.430.000.19.00/262043019	MAINT - REPAIRS - ELEM SCH	\$1,830.00
10-2620.430.000.19.00/262043019	MAINT - REPAIRS - ELEM SCH	\$1,860.00
10-2620.430.000.31.00/262043031	MAINT - REPAIRS - HS	\$1,820.00
10-2620.430.000.31.00/262043031	MAINT - REPAIRS - HS	\$1,480.00
10-2620.430.000.35.00/262043035	MAINT - REPAIRS - MIDDLE SCHOOL	\$910.00
	Vendor Total	\$7,900.00
KUR01 KURTZ BROTHERS		
10-1110.610.000.19.00/1161019	GENERAL SUPPLIES - ELEM SCHOOL	\$277.00
10-1110.610.000.19.00/1161019	GENERAL SUPPLIES - ELEM SCHOOL	\$2,314.88
10-2519.610.000.00.00/2519610	FINANCIAL - GENERAL SUPPLIES	\$28.28
	Vendor Total	\$2,620.16
AVL13 A V LAUTTAMUS COMMUNICATIONS, INC.		
10-2620.430.000.35.00/262043035	MAINT - REPAIRS - MIDDLE SCHOOL	\$515.00
MAI33 MAIELLO, BRUNGO & MAIELLO, LLP		
10-2350.330.000.00.55/235033055	PURCH OTHER PROF SVC	\$750.00

Date: 07/12/18
 Time: 15:40:45

Shaler Area School District
 SUPPLEMENT C.1A 7-18-2018
 2018-2019

Page: 9
 BAR046i

Account Number	Description	Amount
MAS22 THE MASTER TEACHER		
10-2360.610.000.00.00/2360610	SUPT - GENERAL SUPPLIES	\$122.32
MAX53 MAXIM HEALTHCARE SERVICES, INC.		
MAXIM HEALTHCARE SERVICES, INC.		
10-2440.323.000.10.00/244032310	LZ & ES 5/22/18 - 6/1/18	\$1,247.75
10-2440.323.000.10.55/24403231055	LZ, ES, & SWIMMING SUB 5/21/18 - 5/26/18	\$1,515.75
10-2440.323.000.10.55/24403231055	ES, LZ & SWIMMING SUB - 5/14/18 - 5/19/18	\$1,501.50
10-2440.323.000.10.55/24403231055	LZ 5/21/18	\$57.75
10-2440.323.000.10.98/24403231098	ES 6/13/18 - 6/15/18	\$210.00
10-2440.323.000.30.00/244032330	JB, SP, EN, JM & AM 5/22/18 - 6/1/18	\$3,671.50
10-2440.323.000.30.55/24403233055	JB, SP, EN & JM - 5/21/18 - 5/26/18	\$2,626.75
10-2440.323.000.30.55/24403233055	EN, JB, SP, JM & AM - 5/14/18 - 5/19/18	\$2,803.50
10-2440.323.000.30.55/24403233055	EN, JM & AM 5/21/18, 6/4/18 - 6/8/16	\$2,996.00
10-2440.323.000.30.98/24403233098	JB 6/11/18 - 6/15/18	\$1,470.00
	Vendor Total	\$18,100.50
MAR15 MARS HOME FOR YOUTH		
MHY FAMILY SERVICES		
10-1442.568.000.31.00/144256831	ALTERNATIVE EDUCATION - MAY 2018 - SM	\$2,100.00
MIH01 MIHM RENTAL & SALES		
MIHM EQUIPMENT & PARTY PLACE RENTAL		
10-3228.610.000.00.00/3228610	RENTAL OF 400 GRAY BANQUET CHAIRS FOR GRADUATION	\$556.80
TM31 THOMAS MISKO		
10-2380.584.000.31.00/238058431	JANUARY - JUNE 2018 TRAVEL EXPENSES	\$251.75
MIT30 MITCHELL MATTHEW J		
10-5130.880.000.00.00/5130880	REFUND FOR TAX YEAR 2017	\$481.43
MOB23 MOBILE STORAGE GROUP		
MOBILE MINI		
10-2620.430.000.15.00/262043015	MAINT - REPAIRS - ROGERS	\$88.57
10-2620.442.000.31.00/262044231	RENTAL-EQUIP&VEHICLES	\$75.00
10-2620.442.000.31.00/262044231	RENTAL-EQUIP&VEHICLES	\$83.36
10-2620.442.000.35.00/262044235	RENTAL-EQUIP&VEHICLES	\$67.00
10-2620.442.000.35.00/262044235	RENTAL-EQUIP&VEHICLES	\$67.00
	Vendor Total	\$380.93
MON16 MON D AID CLEANIT CO		
MON-D-AID & CLEANIT CO., INC.		
10-2620.610.000.13.23/6101323	MAINT - GEN SUP - MARZOLF	\$59.14
10-2620.610.000.14.23/6101423	MAINT - GEN SUP - RESERVE	\$49.19
10-2620.610.000.35.23/6103523	MAINT - GEN SUP - MS	\$176.68
	Vendor Total	\$285.01
MOS51 MOSYLE CORPORATION		
MOSYLE CORPORATION		
10-2818.618.000.00.00/2818618	SOFTWARE SUPPLIES & LICENSING	\$13,084.50
MRJ03 MR JOHN OF PITTSBURGH		
10-2620.430.000.31.23/4303123	MAINT - REPAIRS - HIGH SCHOOL	\$115.00
10-2620.430.000.31.23/4303123	MAINT - REPAIRS - HIGH SCHOOL	\$105.00
10-2620.430.000.31.23/4303123	MAINT - REPAIRS - HIGH SCHOOL	\$105.00
10-2620.430.000.31.23/4303123	MAINT - REPAIRS - HIGH SCHOOL	\$105.00
10-2620.430.000.35.00/262043035	MAINT - REPAIRS - MIDDLE SCHOOL	\$547.00
10-2620.430.000.35.23/4303523	MAINT - REPAIRS - MIDDLE SCHOOL	\$105.00

Date: 07/12/18
 Time: 15:40:46

Shaler Area School District
 SUPPLEMENT C.1A 7-18-2018
 2018-2019

Page: 10
 BAR046i

Account Number	Description	Amount
		Vendor Total
		\$1,082.00
MSZ01 SUSAN ELIZABETH MSZYCO		
SUSAN ELIZABETH MSZYCO		
10-2140.330.000.30.00/214033030	TWO COMPLETE ASSESSMENT AND EVALUATION REPORTS - KK & LK	\$1,000.00
10-2140.330.000.30.00/214033030	FULL ASSESSMENT AND EVAL REPORT - MB	\$500.00
		Vendor Total
		\$1,500.00
NAP21 NAPA AUTO/TRUCK PARTS OF ETNA		
10-2650.610.000.01.00/265061001	GATOR REPAIR KIT	\$21.99
NEO01 NEOPOST		
MAILFINANCE		
10-2519.442.000.00.00/2510442	4-20-18 - 7-19-18	\$996.36
10-2519.610.000.00.00/2519610	PART REPLACEMENT - SERVICE CALL - INK CARTRIDGE	\$190.00
10-2519.610.000.00.00/2519610	FINANCIAL - GENERAL SUPPLIES	\$148.00
		Vendor Total
		\$1,334.36
01KB KATHLEEN BAUER NEWPORT		
10-2160.582.000.30.55/21605823055	JANUARY THROUGH JUNE 2018 - MILEAGE	\$379.60
NIC06 NICKLAS SUPPLY		
10-2620.610.000.35.00/262061035	MAINT - GEN SUP - MS	\$42.38
10-2620.610.000.35.00/262061035	MAINT - GEN SUP - MS	\$22.59
10-2620.610.000.35.00/262061035	MAINT - GEN SUP - MS	\$30.39
10-2620.610.000.35.00/262061035	MAINT - GEN SUP - MS	\$5.84
		Vendor Total
		\$101.20
NOR29 NORTHEASTERN ENVELOPE CO		
10-1110.610.000.11.00/1161011	GENERAL SUPPLIES - BURCHFIELD	\$166.34
10-1110.610.000.12.00/1161012	GENERAL SUPPLIES - JEFFERY	\$83.17
10-1110.610.000.13.00/1161013	GENERAL SUPPLIES - MARZOLF	\$166.34
10-1110.610.000.14.00/1161014	GENERAL SUPPLIES - RESERVE	\$166.34
10-1110.610.000.15.00/1161015	GENERAL SUPPLIES - ROGERS	\$83.17
10-1110.610.000.19.00/1161019	GENERAL SUPPLIES - ELEM SCHOOL	\$224.00
10-1110.610.000.31.00/1161031	GENERAL SUPPLIES - HIGH SCHOOL	\$514.59
10-1110.610.000.35.00/1161035	GENERAL SUPPLIES - MIDDLE SCHOOL	\$613.41
10-2111.610.000.10.00/211061010	PUPIL PERS - GEN SUP - ELEM	\$43.48
10-2111.610.000.30.00/211061030	PUPIL PERS - GENERAL SUPPLIES - SECONDARY	\$43.48
10-2330.610.000.00.00/2330610	GENERAL SUPPLIES	\$783.56
10-2519.610.000.00.00/2519610	FINANCIAL - GENERAL SUPPLIES	\$640.60
		Vendor Total
		\$3,528.48
PEN30 PENNSYLVANIA STATE UNIV		
10-2818.618.000.00.00/2818618	SOFTWARE SUPPLIES & LICENSING	\$50.00
PER30 PERIATHAMBY ANTHONY R		
10-5130.880.000.00.00/5130880	REFUND FOR TAX YEAR 2017	\$203.07
PES06 PESTCO INC		
10-2620.430.000.11.23/4301123	MAINT - REPAIRS - BURCHFIELD	\$65.00
10-2620.430.000.13.23/4301323	MAINT - REPAIRS - MARZOLF	\$40.00
10-2620.430.000.14.23/4301423	MAINT - REPAIRS - RESERVE	\$30.00
10-2620.430.000.19.23/4301923	MAINT - REPAIRS - ELEM SCHOOL	\$40.00
10-2620.430.000.19.23/4301923	MAINT - REPAIRS - ELEM SCHOOL	\$120.00
10-2620.430.000.19.23/4301923	MAINT - REPAIRS - ELEM SCHOOL	\$120.00
10-2620.430.000.31.23/4303123	MAINT - REPAIRS - HIGH SCHOOL	\$255.55

Date: 07/12/18
 Time: 15:40:46

Shaler Area School District
SUPPLEMENT C.1A 7-18-2018
2018-2019

Page: 11
 BAR046i

Account Number	Description	Amount
PES06 PESTCO INC		
10-2620.430.000.35.23/4303523	MAINT - REPAIRS - MIDDLE SCHOOL	\$200.00
	Vendor Total	\$870.55
PIT20 PITTSBURGH SWEET TREATS		
10-1110.610.184.00.96/111061018496	STEAM CAM WORKSHOP - SWEET ADVENTURES	\$84.00
PIT46 PITTSBURGH WATER COOLER		
10-2360.610.000.00.00/2360610	SUPT - GENERAL SUPPLIES	\$6.95
10-2360.610.000.00.00/2360610	SUPT - GENERAL SUPPLIES	\$6.95
10-2360.610.000.00.00/2360610	SUPT - GENERAL SUPPLIES	\$21.00
	Vendor Total	\$34.90
PIT06 PITT SPECIALTY SUPPLY, INC		
10-2620.610.000.01.23/6100123	MAINT - GEN SUP - B&G	\$2,102.66
10-2620.610.000.11.23/6101123	MAINT - GEN SUP - BURCHFIELD	\$136.52
10-2620.610.000.13.23/6101323	MAINT - GEN SUP - MARZOLF	\$293.93
10-2620.610.000.14.23/6101423	MAINT - GEN SUP - RESERVE	\$240.91
10-2620.610.000.15.23/6101523	MAINT - GEN SUP - ROGERS	\$1,710.97
10-2620.610.000.19.23/6101923	MAINT - GEN SUP - ELEM SCH	\$771.06
10-2620.610.000.31.23/6103123	MAINT - GEN SUP - HS	\$203.72
10-2620.610.000.35.23/6103523	MAINT - GEN SUP - MS	\$163.82
	Vendor Total	\$5,623.59
PME1 PMEA DISTRICT 1		
PMEA		
10-3215.580.000.31.00/321558031	Band/major/flag/drill Tm - HS - TRAVEL	\$138.00
10-3221.580.000.31.00/322158031	Chorus - HS - TRAVEL	\$138.00
	Vendor Total	\$276.00
PPG56 PPG ARCHITECTURAL COATINGS		
PPG ARCHITTECTORAL FINISHES		
10-2620.610.000.13.00/262061013	MAINT - GEN SUP - MARZOLF	\$64.57
10-2620.610.000.13.00/262061013	MAINT - GEN SUP - MARZOLF	\$64.04
10-2620.610.000.13.00/262061013	MAINT - GEN SUP - MARZOLF	\$67.14
10-2620.610.000.19.00/262061019	MAINT - GEN SUP - ELEM SCH	\$2.20
10-2620.610.000.19.00/262061019	MAINT - GEN SUP - ELEM SCH	\$74.38
10-2620.610.000.19.00/262061019	MAINT - GEN SUP - ELEM SCH	\$190.74
10-2620.610.000.19.00/262061019	MAINT - GEN SUP - ELEM SCH	\$17.58
	Vendor Total	\$480.65
PRE09 PRENTKE ROMICH CO		
10-1241.750.000.10.00/124175010	ELEMENTARY - EQUIP-ORIGINAL & ADDL	\$160.00
PYR21 PYRAMID SCHOOL PRODUCTS		
10-2620.610.000.11.23/6101123	MAINT - GEN SUP - BURCHFIELD	\$231.30
10-2620.610.000.14.23/6101423	MAINT - GEN SUP - RESERVE	\$87.01
10-2620.610.000.15.23/6101523	MAINT - GEN SUP - ROGERS	\$451.25
10-2620.610.000.19.23/6101923	MAINT - GEN SUP - ELEM SCH	\$361.01
10-2620.610.000.31.23/6103123	MAINT - GEN SUP - HS	\$593.05
10-2620.610.000.35.23/6103523	MAINT - GEN SUP - MS	\$737.75
	Vendor Total	\$2,461.37
RAP54 RAPTOR TECHNOLOGIES, LLC		
10-2818.618.000.00.00/2818618	SOFTWARE SUPPLIES & LICENSING	\$3,570.00

Date: 07/12/18
 Time: 15:40:46

Shaler Area School District
 SUPPLEMENT C.1A 7-18-2018
 2018-2019

Page: 12
 BAR046i

Account Number	Description	Amount
CR31 CLINT RAUSCHER		
10-3251.581.000.00.00/3251581	CELL PHONE REIMBURSEMENT JULY 2018	\$30.00
RAY01 RAYBURG APPLIANCE SERVICE, INC.		
10-2620.434.000.19.00/262043419	Operation/bldg Svc - MAINT. REPAIRS KITCHEN	\$136.00
10-2620.434.000.31.00/262043431	Operation/bldg Svc - MAINT. REPAIRS KITCHEN	\$105.00
10-2620.434.000.35.00/262043435	Operation/bldg Svc - MAINT. REPAIRS KITCHEN	\$330.31
	Vendor Total	\$571.31
89RR ROGER RECH (HS)		
10-2111.580.000.30.00/211058030	TRANSITION & SPECIAL ED TRAVEL EXPENSES	\$223.45
ALL55 ALLIED WASTE SERVICES REPUBLIC SERVICES, INC.		
10-2620.411.000.01.00/262041101	MAINT -DISPOSAL SERVICES - BUTLER PLANK	\$315.00
10-2620.411.000.11.00/262041111	MAINT -DISPOSAL SERVICES - BURCHFIELD	\$313.95
10-2620.411.000.12.00/262041112	MAINT - DISPOSAL SERVICES - JEFFERY	\$307.65
10-2620.411.000.13.00/262041113	MAINT - DISPOSAL SERVICES - MARZOLF	\$313.95
10-2620.411.000.14.00/262041114	MAINT - DISPOSAL SERVICES - RESERVE	\$304.50
10-2620.411.000.19.00/262041119	MAINT - Disposal Services - ELEM SCHOOL	\$599.55
10-2620.411.000.31.00/262041131	MAINT - DISPOSAL SERVICES - HS	\$479.54
10-2620.411.000.31.00/262041131	MAINT - DISPOSAL SERVICES - HS	\$782.24
10-2620.411.000.35.00/262041135	MAINT - DISPOSAL SERVICES - MIDDLE SCHOOL	\$599.55
	Vendor Total	\$4,015.93
RIC53 RICCI'S REPAIR, LLC		
10-2650.433.000.00.00/2650433	ANNUAL STATE INSPECTION	\$113.00
10-2650.433.000.00.00/2650433	Vehicle Oper & Maint - Repairs & Maintenance Srvcs Vehi	\$560.31
	Vendor Total	\$673.31
RID01 RIDDELL RIDDELL / ALL AMERICAN SPORTS CORP		
10-3265.610.000.00.00/3265610	Football - GENERAL SUPPLIES	\$8,871.95
ROE10 PATRICIA M ROBINSON PATRICIA M ROBINSON		
10-2140.330.000.10.00/214033010	BL & JC	\$800.00
ROS01 ROSEN PUBLISHING CO		
10-2250.640.000.31.00/225064031	LIBRARY - BOOKS - HS	\$27.95
ROS06 ROSSI FLOOR TECHNOLOGIES		
10-2620.430.000.01.00/262043001	MAINT - REPAIRS - BUTLER PLK	\$122.50
10-2620.430.000.11.00/262043011	MAINT - REPAIRS - BURCHFIELD	\$85.84
	Vendor Total	\$208.34
TR31 TIMOTHY ROYALL		
10-2380.584.000.31.00/238058431	MAY - JUNE 2018 TRAVEL EXPENSES	\$100.15
SCH44 SCHAEGLER YESCO		
10-2620.610.000.11.00/262061011	MAINT - GEN SUP - BURCHFIELD	\$14.34
10-2620.610.000.11.00/262061011	MAINT - GEN SUP - BURCHFIELD	\$135.99
10-2620.610.000.19.00/262061019	MAINT - GEN SUP - ELEM SCH	\$1,540.66
10-2620.610.000.31.00/262061031	MAINT - GEN SUP - HS	\$1,587.34
10-2620.610.000.35.00/262061035	MAINT - GEN SUP - MS	\$856.00
10-2620.610.000.35.00/262061035	MAINT - GEN SUP - MS	\$684.66
	Vendor Total	\$4,818.99

Date: 07/12/18
 Time: 15:40:46

Shaler Area School District
 SUPPLEMENT C.1A 7-18-2018
 2018-2019

Page: 13
 BAR046i

Account Number	Description	Amount
SCH57 SCHOOLDUDE.COM		
10-1110.618.000.11.00/1161811	SOFTWARE SUPPLIES & LICENSING - BURCHFIELD	\$405.50
10-1110.618.000.13.00/1161813	SOFTWARE SUPPLIES & LICENSING - MARZOLF	\$405.50
10-1110.618.000.14.00/1161814	SOFTWARE SUPPLIES & LICENSING - RESERVE	\$405.50
10-1110.618.000.15.00/1161815	SOFTWARE SUPPLIES & LICENSING - ROGERS	\$405.50
10-1110.618.000.19.00/1161819	SOFTWARE SUPPLIES & LICENSING - ELEM SCHOOL	\$442.38
10-1110.618.000.31.00/1161831	INSTRUCTIONAL - SOFTWARE SUP & LICENSING - HIGH SCHOOL	\$589.90
10-1110.618.000.35.00/1161835	SOFTWARE SUPPLIES & LICENSING - MIDDLE SCHOOL	\$442.37
	Vendor Total	\$3,096.65
DEC01 SCHOOLFIX		
DECKER INC		
10-2620.610.000.31.00/262061031	MAINT - GEN SUP - HS	\$37.67
SIA23 SCHOOL INFO APP, LLC		
SchoolInfoApp, LLC		
10-1110.610.000.31.00/1161031	GENERAL SUPPLIES - HIGH SCHOOL	\$1,000.00
SCH56 SCHOOL SPECIALTY INC		
10-2519.610.000.00.00/2519610	FINANCIAL - GENERAL SUPPLIES	\$93.60
SCO06 SCOTT ELECTRIC		
10-2620.610.000.11.00/262061011	MAINT - GEN SUP - BURCHFIELD	\$343.66
10-2620.610.000.11.00/262061011	MAINT - GEN SUP - BURCHFIELD	\$3,221.67
	Vendor Total	\$3,565.33
SHA19 MEGAN SHARRETT'S		
10-0422.001.000.00.00/0422001	DUE PROCESS - JL	\$450.00
SOI53 SOILS INC.		
SOILS INCORPORATED		
10-2630.610.000.31.00/263061031	MAINT UP-KEEP - GEN SUP - HS	\$748.76
SPO16 SPORTS TURF SPECIALTIES		
10-3277.430.000.00.00/3277430	Softball - Repairs/maintenance	\$1,723.00
STE21 STERATORE SUPPLY, INC		
STERATORE SANITARY SUPPLY		
10-2620.610.000.01.23/6100123	MAINT - GEN SUP - B&G	\$191.40
10-2620.610.000.11.23/6101123	MAINT - GEN SUP - BURCHFIELD	\$7,918.35
10-2620.610.000.13.23/6101323	MAINT - GEN SUP - MARZOLF	\$5,230.40
10-2620.610.000.14.23/6101423	MAINT - GEN SUP - RESERVE	\$4,034.85
10-2620.610.000.15.23/6101523	MAINT - GEN SUP - ROGERS	\$8,029.95
10-2620.610.000.15.23/6101523	MAINT - GEN SUP - ROGERS	\$217.20
10-2620.610.000.15.23/6101523	MAINT - GEN SUP - ROGERS	\$249.00
10-2620.610.000.19.23/6101923	MAINT - GEN SUP - ELEM SCH	\$10,921.10
10-2620.610.000.31.23/6103123	MAINT - GEN SUP - HS	\$18,893.15
10-2620.610.000.35.23/6103523	MAINT - GEN SUP - MS	\$13,617.30
	Vendor Total	\$69,302.70
SUN56 SUNBURY CONTROLS, INC.		
10-2620.610.000.01.00/262061001	MAINT - GEN SUP - B&G	\$257.60
10-2620.610.000.31.00/262061031	MAINT - GEN SUP - HS	\$162.55
	Vendor Total	\$420.15

Date: 07/12/18
 Time: 15:40:46

Shaler Area School District
 SUPPLEMENT C.1A 7-18-2018
 2018-2019

Page: 14
 BAR046i

Account Number	Description	Amount
POW23 TACONY CORPORATION		
TACONY CORPORATION		
10-2620.610.000.31.00/262061031	MAINT - GEN SUP - HS	\$561.80
10-2620.610.000.31.23/6103123	MAINT - GEN SUP - HS	\$513.99
10-2620.751.000.15.00/262075115	Operation/bldg Svc	\$602.64
	Vendor Total	\$1,678.43
TUC08 TUCKER ARENSBERG, PC		
10-2350.330.000.00.00/2350330	RETAINER	\$850.00
10-2350.330.000.00.00/2350330	GENERAL	\$2,200.00
10-2350.330.000.00.00/2350330	PERSONNEL	\$192.00
10-2350.330.000.00.55/235033055	SPECIAL EDUCATION MATTERS	\$656.00
10-2350.332.000.00.00/2350332	DELINQUENT TAX COLLECTIONS	\$1,842.00
10-2350.332.000.00.00/2350332	P.L. - PROCESS REQUEST AND PREPARE LETTER TO PAMS	\$34.00
10-2350.333.000.00.00/2350333	2017 TAX ASSESSMENT APPEALS	\$840.00
10-2350.333.000.00.00/2350333	2018 TAX ASSESSMENT APPEALS	\$2,614.25
	Vendor Total	\$9,228.25
UGI53 UGI ENERGY SERVICES, LLC		
10-2620.621.000.14.00/262062114	5/17/18 - 6/18/18	\$25.15
ULI21 ULINE		
10-2520.750.000.15.00/252075015	3 X 5 BLANK INV LBL	\$56.08
UNI40 UNIVERSITY OF PITTSBURGH		
UNIVERSITY OF PITTSBURGH		
10-2140.810.000.30.00/214081030	WORKSHOP - 6/27/18 - KATHI GRACZYK	\$140.00
UPM52 UPMC		
10-3299.330.000.00.00/3299330	Misc Athletics - PURCH OTHER PROF SVC	\$9,500.00
VAN30 VANDERBERG APOLO L & RACHEL		
10-5130.880.000.00.00/5130880	REFUND FOR TAX YEAR 2017	\$444.92
VAN57 VANGUARD FIDUCIARY TRUST CO		
10-1241.280.000.00.00/1241280	UNUSED SICK DAYS PER COLLECTIVE BARGAINING AGREEMENT - L LEG	\$2,050.00
VOY01 VOYAGER SOPRIS LEARNING		
VOYAGER SOPRIS LEARNING		
10-1190.640.411.12.00/119064041112	Regular Instruction-Federal Prog - Books	\$6,262.58
10-1190.640.411.13.00/119064041113	Regular Instruction-Federal Prog - Books	\$12,525.15
10-1190.640.411.14.00/119064041114	Regular Instruction-Federal Prog - Books	\$6,262.57
	Vendor Total	\$25,050.30
WAT17 THE WATSON INSTITUTE		
THE WATSON INSTITUTE		
10-1233.561.000.10.98/12335611098	ESY - WISP CAMP 1 ON 1 FOR ES	\$6,075.00
10-1233.561.000.10.98/12335611098	ESY - HM & EN	\$4,430.00
	Vendor Total	\$10,505.00
WAT03 THE EDUCATION CENTER / WATSON INSTITUTE		
THE EDUCATION CENTER AT WATSON INST		
10-1233.561.000.98.00/123356198	JUNE & JULY 2018 - AG, AH, MH, EN, LW, MH	\$15,150.00
WAV51 WAVES EQUIPMENT SOURCE, INC.		
10-2620.430.000.01.00/262043001	MAINT - REPAIRS - BUTLER PLK	\$10.24
10-2620.610.000.01.00/262061001	MAINT - GEN SUP - B&G	\$10.24
10-2630.430.000.14.00/263043014	GROUNDS UP-KEEP - MAINT - RESERVE	\$75.00

Date: 07/12/18
 Time: 15:40:46

Shaler Area School District
 SUPPLEMENT C.1A 7-18-2018
 2018-2019

Page: 15
 BAR046i

Account Number	Description	Amount
Vendor Total		\$95.48
CW31 CRAIG WELLS		
10-2271.581.000.31.00/227158131	PBIS IMPLEMENTER'S FORUM, HERSHEY PA, MEALS	\$13.00
TW31 TARA WELLS		
10-1110.610.184.00.96/111061018496	REIMBURSEMENT FOR STEAM CAMP SUPPLIES - MAKE-A-CAKE	\$7.98
10-1110.610.184.00.96/111061018496	REIMBURSEMENT FOR STEAM CAMP SUPPLIES - MAKE-A-CAKE	\$8.92
10-1110.610.184.00.96/111061018496	REIMBURSEMENT FOR STEAM CAMP SUPPLIES - TARGET	\$29.35
Vendor Total		\$46.25
WES36 WESTERN PA SCHOOL FOR BLIND CHILDREN		
10-1224.323.000.30.00/122432330	JB - MAY 2018	\$767.25
WIL20 GEORGE L WILSON & CO., INC.		
10-2620.610.000.31.00/262061031	MAINT - GEN SUP - HS	\$125.00
WIL33 WILSON LANGUAGE TRAINING CORP.		
10-1110.640.000.12.05/116401205	JEFFERY - BOOKS	\$583.74
10-1110.640.000.12.05/116401205	CREDIT INV #1699504	\$-98.00
10-1110.640.000.12.05/116401205	JEFFERY - BOOKS	\$6,860.85
10-1110.640.000.15.05/116401505	ROGERS - BOOKS	\$-425.00
10-1110.640.000.15.05/116401505	ROGERS - BOOKS	\$6,860.85
10-1110.640.000.15.05/116401505	ROGERS - BOOKS	\$583.74
Vendor Total		\$14,366.18
WOO55 WOODLANDS FOUNDATION		
10-1290.322.000.30.98/12903223098	Z.E. - TEEN CAMP WOODLANDS - ESY JUNE 24-29, 2018	\$1,100.00
01TW THOMAS J WYANT		
10-2818.584.000.00.00/2818584	JANUARY THROUGH JUNE 2018 MILEAGE	\$102.73
KB14 KIM YOUNG		
10-1110.610.184.00.96/111061018496	REIMBURSEMENT FOR PURCHASE FOR STEAM CAMP WORKSHOP - AMAZON	\$10.00
10-1110.610.184.00.96/111061018496	REIMBURSEMENT FOR PURCHASE FOR STEAM CAMP WORKSHOPS - SHOP N	\$0.99
10-1110.610.184.00.96/111061018496	REIMBURSEMENT FOR PURCHASE FOR STEAM CAMP WORKSHOP - GIANT E	\$18.89
10-1110.610.184.00.96/111061018496	REIMBURSEMENT FOR PURCHASE FOR STEAM CAMP WORKSHOP - AMAZON	\$19.06
10-1110.610.184.00.96/111061018496	REIMBURSEMENT FOR PURCHASE FOR STEAM CAMP WORKSHOP - DOLLAR	\$15.00
Vendor Total		\$63.94
Report Total		\$711,486.40

Date: 07/12/18

Time: 20:02:16

Release Dates 08/31/07 - 12/10/18

Shaler Area School District

Invoices Payables 2017-2018

Vendor # 01BB - rai21

Page: 1

BAR046k

Invoice # 001465 - US05222

Vendor#	Vendor Name	Description	Amount
17-18	Year		
	Fund 31		
	15 Rogers Elementary		
A1E	A-1 ELECTRIC	SCOTT PRIMARY - ELECTRICAL CONTRACT	\$60,709.75
BOV59	BOVA CORPORATION	SCOTT PRIMARY - FOOD SERVICE EQUIPMENT	\$24,388.55
COM88	COMMUNICATIONS CONSULTING, INC.	SCOTT PRIMARY - TECHNOLOGY	\$12,931.62
EAS07	EAST WEST MANUFACTURING & SUPPLY CO	SCOTT PRIMARY - EAST WEST MANUFACTURING	\$63,579.60
GAT08	GATEWAY ENGINEERS INC.	SCOTT PRIMARY - GATEWAY ENGINEERS	\$4,750.00
PEM03	HON C/O PEMCO	SCOTT PRIMARY - Equip-original & Addl	\$124.20
		SCOTT PRIMARY - Equip-original & Addl	\$34,247.85
		SCOTT PRIMARY - Equip-original & Addl	\$5,472.00
MAS38	MASSARO CM SERVICES, LLC	SCOTT PRIMARY - CONSTRUCTION MANAGEMENT	\$25,935.26
NEL17	NELLO CONSTRUCTION	SCOTT PRIMARY - GENERAL CONSTRUCTION	1,231,326.05
SAR22	SARGENT ELECTRIC COMPANY	SCOTT PRIMARY - TELEDATA CABLING	\$7,825.15
SUN02	SUNESYS, LLC	Scott Primary - Crown Castle	\$15,817.00
VRA44	VRABEL PLUMBING	SCOTT PRIMARY - PLUMBING	\$12,498.50
		Total for 15 Rogers Elementary	\$1,499,605.53
	35 Mt. Royal Middle School		
TPK01	TPK, INC.	TITAN STADIUM - SITE CONSTRUCTION	\$3,500.00
		Total for Fund 31	\$1,503,105.53
	17-18 \$1,503,105.53	Report Total	\$1,503,105.53

Date: 07/12/18

Time: 20:31:56

Ending Date: 06/30/18

Shaler Area School District

2017-2018

Page: 1

BAR020A

Expenditure Accounts - with Activity Only

FUNCTION BOARD SUPPLEMENT

	Adjusted Budget	YTD Expended	Current Expended	Current Encumbrances	Remaining Balance	Used
ALL						
10 Fund 10						
1000 Instruction						
1100 Instruction-regular Prog						
100 Salaries	19,689,539.00	16,206,105.48	2,225,316.94	0.00	3,483,433.52	82
200 Benefits	13,230,605.00	10,685,155.88	1,253,703.00	0.00	2,545,449.12	81
300 Purchased Prof/tech Svc	55,650.00	4,819.13	0.00	2,250.00	48,580.87	13
400 Purchased Property Svc	47,450.00	31,228.78	5,350.17	7,942.85	8,278.37	83
500 Other Purchased Services	1,358,025.00	787,893.91	188,664.13	0.00	570,131.09	58
600 Supplies	1,047,895.00	607,238.16	5,751.91	73,438.54	367,218.30	65
700 Property	229,385.00	103,675.31	1,330.36	299.00	125,410.69	45
800 Other Objects	0.00	668.00	468.00	0.00	-668.00	-999
1100 ** Functio Total	35,658,549.00	28,426,784.65	3,680,584.51	83,930.39	7,147,833.96	80
1200 Instruction-special Prog						
100 Salaries	5,323,986.00	5,363,426.40	572,664.11	0.00	-39,440.40	101
200 Benefits	3,665,523.00	3,932,118.13	392,034.95	0.00	-266,595.13	107
300 Purchased Prof/tech Svc	966,014.00	516,135.21	45,268.78	0.00	449,878.79	53
500 Other Purchased Services	1,954,863.00	1,590,628.58	847,299.41	0.00	364,234.42	81
600 Supplies	46,207.00	35,437.16	2,047.59	303.46	10,466.38	77
700 Property	57,750.00	11,844.53	3,703.45	7,147.49	38,757.98	33
800 Other Objects	0.00	2,942.50	0.00	0.00	-2,942.50	-999
1200 ** Functio Total	12,014,343.00	11,452,532.51	1,863,018.29	7,450.95	554,359.54	95
1300 Vocational Education						
100 Salaries	53,702.00	44,792.00	4,072.00	0.00	8,910.00	83
200 Benefits	22,325.00	18,549.26	1,685.65	0.00	3,775.74	83
400 Purchased Property Svc	4,000.00	0.00	0.00	0.00	4,000.00	0
500 Other Purchased Services	1,332,000.00	1,472,739.05	0.00	0.00	-140,739.05	111
1300 ** Functio Total	1,412,027.00	1,536,080.31	5,757.65	0.00	-124,053.31	109
1400 Other Instruct Prog						
100 Salaries	759,533.00	415,848.43	66,387.87	0.00	343,684.57	55
200 Benefits	460,574.00	264,053.11	38,041.14	0.00	196,520.89	57
300 Purchased Prof/tech Svc	15,000.00	0.00	0.00	0.00	15,000.00	0
500 Other Purchased Services	220,500.00	119,799.75	16,941.77	1,600.00	99,100.25	55
600 Supplies	13,088.00	471.20	0.00	64,809.05	-52,192.25	499
800 Other Objects	0.00	125.00	0.00	0.00	-125.00	-999
1400 ** Functio Total	1,468,695.00	800,297.49	121,370.78	66,409.05	601,988.46	59

Date: 07/12/18

Time: 20:31:56

Ending Date: 06/30/18

Shaler Area School District
2017-2018

Expenditure Accounts - with Activity Only

FUNCTION BOARD SUPPLEMENT

	Adjusted Budget	YTD Expended	Current Expended	Current Encumbrances	Remaining Balance	%Used
ALL						
10 Fund 10						
1000 Instruction						
1500 Non-public School Programs						
300 Purchased Prof/tech Svc	0.00	14,966.00	14,966.00	0.00	-14,966.00	-999
1500 ** Functio Total	0.00	14,966.00	14,966.00	0.00	-14,966.00	-999
1000 ** Function (E) Total	50,553,614.00	42,230,660.96	5,685,697.23	157,790.39	8,165,162.65	84
2000 Support Services						
2100 Pupil Personnel						
100 Salaries	1,546,874.00	1,728,353.55	209,980.44	0.00	-181,479.55	112
200 Benefits	1,009,483.00	1,143,376.31	122,393.17	0.00	-133,893.31	113
300 Purchased Prof/tech Svc	45,570.00	65,558.88	2,660.00	0.00	-19,988.88	144
400 Purchased Property Svc	1,313.00	609.77	0.00	0.00	703.23	46
500 Other Purchased Services	7,141.00	6,682.05	2,868.93	323.53	135.42	98
600 Supplies	49,078.00	16,486.78	900.63	86.96	32,504.26	34
800 Other Objects	1,260.00	724.00	0.00	0.00	536.00	57
2100 ** Functio Total	2,660,719.00	2,961,791.34	338,803.17	410.49	-301,482.83	111
2200 Instructional Staff Svc						
100 Salaries	596,574.00	712,243.45	58,741.81	0.00	-115,669.45	119
200 Benefits	287,852.00	450,058.21	36,818.52	0.00	-162,206.21	156
300 Purchased Prof/tech Svc	59,300.00	114,208.91	5,000.00	22,026.28	-76,935.19	230
400 Purchased Property Svc	4,376.00	593.74	0.00	0.00	3,782.26	14
500 Other Purchased Services	6,410.00	10,145.31	2,403.14	0.00	-3,735.31	158
600 Supplies	150,475.00	147,757.42	675.20	1,075.73	1,641.85	99
700 Property	8,800.00	8,259.69	507.95	471.23	69.08	99
800 Other Objects	0.00	116.00	0.00	0.00	-116.00	-999
2200 ** Functio Total	1,113,787.00	1,443,382.73	104,146.62	23,573.24	-353,168.97	132
2300 Administration						
100 Salaries	2,036,356.00	2,185,267.67	179,771.77	0.00	-148,911.67	107
200 Benefits	1,291,958.00	1,356,237.25	110,606.10	0.00	-64,279.25	105
300 Purchased Prof/tech Svc	416,000.00	239,918.12	11,795.47	0.00	176,081.88	58
400 Purchased Property Svc	32,450.00	46,472.92	6,542.36	0.00	-14,022.92	143
500 Other Purchased Services	164,120.00	62,541.87	11,965.19	0.00	101,578.13	38
600 Supplies	25,700.00	18,883.83	1,845.02	1,139.43	5,676.74	78
700 Property	5,000.00	3,506.00	0.00	0.00	1,494.00	70

Date: 07/12/18

Time: 20:31:56

Ending Date: 06/30/18

Shaler Area School District
2017-2018

Expenditure Accounts - with Activity Only

FUNCTION BOARD SUPPLEMENT

	Adjusted Budget	YTD Expended	Current Expended	Current Encumbrances	Remaining Balance	Used
ALL						
10 Fund 10						
2000 Support Services						
2300 Administration						
800 Other Objects	54,320.00	24,410.29	14,385.29	0.00	29,909.71	45
2300 ** Functio Total	4,025,904.00	3,937,237.95	336,911.20	1,139.43	87,526.62	98
2400 Pupil Health						
100 Salaries	520,809.00	494,686.87	69,703.03	0.00	26,122.13	95
200 Benefits	353,317.00	325,274.99	38,843.99	0.00	28,042.01	92
300 Purchased Prof/tech Svc	334,675.00	216,928.27	27,938.91	0.00	117,746.73	65
400 Purchased Property Svc	893.00	1,594.47	450.00	0.00	-701.47	179
500 Other Purchased Services	336.00	98.44	56.43	0.00	237.56	29
600 Supplies	12,337.00	9,932.02	541.84	30.46	2,374.52	81
700 Property	851.00	1,063.47	0.00	0.00	-212.47	125
2400 ** Functio Total	1,223,218.00	1,049,578.53	137,534.20	30.46	173,609.01	86
2500 Business						
100 Salaries	413,542.00	400,922.18	30,802.66	0.00	12,619.82	97
200 Benefits	253,842.00	262,647.75	21,648.73	0.00	-8,805.75	103
300 Purchased Prof/tech Svc	35,000.00	41,521.50	5,746.00	0.00	-6,521.50	119
400 Purchased Property Svc	67,550.00	87,315.54	7,246.21	12,935.13	-32,700.67	148
500 Other Purchased Services	13,350.00	1,544.95	1,152.66	0.00	11,805.05	12
600 Supplies	7,500.00	22,094.40	308.67	1,867.56	-16,461.96	319
800 Other Objects	1,100.00	705.00	0.00	0.00	395.00	64
2500 ** Functio Total	791,884.00	816,751.32	66,904.93	14,802.69	-39,670.01	105
2600 Oper & Maint Of Plant						
100 Salaries	2,966,245.90	2,803,372.02	223,866.58	0.00	162,873.88	95
200 Benefits	1,915,157.00	1,862,192.36	149,017.62	0.00	52,964.64	97
300 Purchased Prof/tech Svc	98,398.05	159,503.84	47,169.30	0.05	-61,105.84	162
400 Purchased Property Svc	1,443,869.37	1,421,467.52	115,344.27	33,445.45	-11,043.60	101
500 Other Purchased Services	319,000.00	247,716.39	8,089.57	818.00	70,465.61	78
600 Supplies	665,810.37	530,776.35	31,888.14	140,500.42	-5,466.40	101
700 Property	109,660.21	40,801.86	1,807.71	9,763.72	59,094.63	46
800 Other Objects	1,664.00	2,140.00	992.00	0.00	-476.00	129
2600 ** Functio Total	7,519,804.90	7,067,970.34	578,175.19	184,527.64	267,306.92	96

Date: 07/12/18
 Time: 20:31:57
 Ending Date: 06/30/18

Shaler Area School District
 2017-2018

Expenditure Accounts - with Activity Only

FUNCTION BOARD SUPPLEMENT

	Adjusted Budget	YTD Expended	Current Expended	Current Encumbrances	Remaining Balance	%Used
ALL						
10 Fund 10						
2000 Support Services						
2700 Student Transportation						
100 Salaries	36,008.00	17,706.47	1,280.00	0.00	18,301.53	49
200 Benefits	13,836.00	15,984.23	1,269.12	0.00	-2,148.23	116
300 Purchased Prof/tech Svc	100,000.00	35,070.37	4,377.50	0.00	64,929.63	35
500 Other Purchased Services	5,056,500.00	4,436,960.09	522,475.70	0.00	619,539.91	88
600 Supplies	26,500.00	12,434.07	-16,630.70	0.00	14,065.93	47
2700 ** Functio Total	5,232,844.00	4,518,155.23	512,771.62	0.00	714,688.77	86
2800 Central						
100 Salaries	772,593.00	645,000.08	49,632.63	0.00	127,592.92	83
200 Benefits	480,872.00	432,237.61	34,567.02	0.00	48,634.39	90
300 Purchased Prof/tech Svc	31,100.00	18,948.97	396.00	1,903.50	10,247.53	67
500 Other Purchased Services	15,650.00	6,166.01	840.87	535.17	8,948.82	43
600 Supplies	163,600.00	143,646.09	672.72	17,577.40	2,376.51	99
700 Property	152,000.00	132,806.55	0.00	1,399.00	17,794.45	88
800 Other Objects	2,070.00	3,010.99	0.00	0.00	-940.99	145
2800 ** Functio Total	1,617,885.00	1,381,816.30	86,109.24	21,415.07	214,653.63	87
2900 Other Support Services						
500 Other Purchased Services	61,425.00	61,369.51	0.00	0.00	55.49	100
2900 ** Functio Total	61,425.00	61,369.51	0.00	0.00	55.49	100
2000 ** Function (E) Total	24,247,470.90	23,238,053.25	2,161,356.17	245,899.02	763,518.63	97
3000 Oper Of Non-instr Svc						
3200 Student Activities/ath						
100 Salaries	967,247.00	950,538.65	65,466.47	0.00	16,708.35	98
200 Benefits	105,428.00	419,755.81	31,419.73	0.00	-314,327.81	398
300 Purchased Prof/tech Svc	48,590.77	37,665.00	793.04	9,500.00	1,425.77	97
400 Purchased Property Svc	27,029.28	20,151.48	6,014.97	9,812.49	-2,934.69	111
500 Other Purchased Services	189,234.45	200,893.99	28,917.91	356.18	-12,015.72	106
600 Supplies	94,164.30	96,044.61	1,674.77	2,809.22	-4,689.53	105
700 Property	16,986.77	15,032.33	0.00	125.55	1,828.89	89
800 Other Objects	20,743.53	26,429.00	-495.00	4,374.50	-10,059.97	149
3200 ** Functio Total	1,469,424.10	1,766,510.87	133,791.89	26,977.94	-324,064.71	122

Date: 07/12/18
 Time: 20:31:57
 Ending Date: 06/30/18

Shaler Area School District
 2017-2018

Expenditure Accounts - with Activity Only

FUNCTION BOARD SUPPLEMENT

	Adjusted Budget	YTD Expended	Current Expended	Current Encumbrances	Remaining Balance	Used
ALL						
10 Fund 10						
3000 Oper Of Non-instr Svc						
3300 Community Services						
100 Salaries	40,000.00	59,606.47	4,012.20	0.00	-19,606.47	149
200 Benefits	0.00	17,137.92	823.63	0.00	-17,137.92	-999
400 Purchased Property Svc	5,000.00	1,168.67	0.00	0.00	3,831.33	23
500 Other Purchased Services	700.00	1,200.00	0.00	0.00	-500.00	171
600 Supplies	10,000.00	16,605.94	5,140.80	76.00	-6,681.94	167
800 Other Objects	0.00	16,888.58	0.00	0.00	-16,888.58	-999
3300 ** Functio Total	55,700.00	112,607.58	9,976.63	76.00	-56,983.58	202
3000 ** Function (E) Total	1,525,124.10	1,879,118.45	143,768.52	27,053.94	-381,048.29	125
5000 Other Financing Uses						
5100 See 5102 And 5110						
800 Other Objects	207,086.00	31,599.36	0.00	0.00	175,486.64	15
900 Other Financing Uses	268,798.00	139,077.14	0.00	0.00	129,720.86	52
5100 ** Functio Total	475,884.00	170,676.50	0.00	0.00	305,207.50	36
5200 Fund Transfers						
900 Other Financing Uses	7,034,642.00	7,104,699.20	6,061.74	0.00	-70,057.20	101
5200 ** Functio Total	7,034,642.00	7,104,699.20	6,061.74	0.00	-70,057.20	101
5000 ** Function (E) Total	7,510,526.00	7,275,375.70	6,061.74	0.00	235,150.30	97
10 Fund (E) Total	83,836,735.00	74,623,208.36	7,996,883.66	430,743.35	8,782,783.29	90
Report Totals	83,836,735.00	74,623,208.36	7,996,883.66	430,743.35	8,782,783.29	90

Date: 07/12/18

Time: 20:31:18

Ending Date: 06/30/18

Shaler Area School District
2017-2018

Expenditure Accounts - with Activity Only

OBJECT SUPPLEMENT

	Adjusted Budget	YTD Expended	Current Expended	Current Encumbrances	Remaining Balance	%Used
ALL						
10 Fund 10						
100 Salaries						
111 Sal-administration-reg	2,268,996.00	2,515,846.17	213,161.76	0.00	-246,850.17	111
120 Sal-professional-educ	51,493.00	51,992.46	3,999.42	0.00	-499.46	101
121 Sal-prof-regular	24,682,998.00	21,615,803.30	3,008,023.62	0.00	3,067,194.70	88
122 Sal-prof-substitute	585,000.00	449,251.08	30,774.94	0.00	135,748.92	77
123 Sal-prof-extra Duty	552,100.00	390,943.63	52,760.81	0.00	161,156.37	71
131 Sal-other Professional	269,806.00	217,246.14	18,021.30	0.00	52,559.86	81
132 Sal-coach/sponsor/other	840,000.00	813,296.05	53,478.47	0.00	26,703.95	97
141 Sal-technical Support	157,189.00	36,400.01	2,800.00	0.00	120,788.99	23
151 Sal-clerical-regular	3,211,426.00	3,019,064.30	149,876.00	0.00	192,361.70	94
152 Sal-clerical-subs	132,000.00	89,788.71	4,270.17	0.00	42,211.29	68
153 Sal-clerical-overtime	60,000.00	53,601.48	2,840.45	0.00	6,398.52	89
161 Sal-foremen-regular	147,608.00	147,392.70	11,337.90	0.00	215.30	100
171 Sal-maint-regular	578,211.00	572,126.36	46,083.20	0.00	6,084.64	99
173 Sal-maintenance-overtime	15,955.90	31,658.61	2,171.70	0.00	-15,702.71	198
182 Sal-summer Subs	82,000.00	31,593.36	7,132.19	0.00	50,406.64	39
191 Sal-custodial-regular	1,954,226.00	1,845,249.10	138,435.50	0.00	108,976.90	94
192 Sal-custodial-subs	45,000.00	65,783.05	5,275.00	0.00	-20,783.05	146
193 Sal-custodial-overtime	89,000.00	81,217.96	11,310.08	0.00	7,782.04	91
100 Object (E) Total	35,723,008.90	32,028,254.47	3,761,752.51	0.00	3,694,754.43	90
200 Benefits						
211 Medical Insurance	7,309,237.00	7,285,721.17	609,883.28	0.00	23,515.83	100
212 Dental Insurance	434,758.00	440,075.73	35,938.21	0.00	-5,317.73	101
213 Life Insurance	69,169.00	73,162.11	5,900.66	0.00	-3,993.11	106
215 Eye Care Insurance	73,354.00	74,763.24	6,367.80	0.00	-1,409.24	102
219 Other Health Benefits	171,500.00	130,393.22	21,597.74	0.00	41,106.78	76
220 Social Security	2,721,784.00	2,414,386.83	284,004.54	0.00	307,397.17	89
230 Retirement	11,555,726.00	10,348,111.76	1,219,328.52	0.00	1,207,614.24	90
240 Tuition Reimbursement	6,000.00	11,000.00	1,500.00	0.00	-5,000.00	183
250 Unemployment Comp	160,000.00	17,388.20	0.00	0.00	142,611.80	11
260 Workers Compensation	286,101.00	321,001.91	37,609.23	0.00	-34,900.91	112
280 Other Post Employment Benefits	100,000.00	5,375.00	0.00	0.00	94,625.00	5
281 RETIREE REIMBURSEMENT	201,143.00	63,557.48	10,764.48	0.00	137,585.52	32
290 Other Benefits	2,000.00	0.00	0.00	0.00	2,000.00	0
200 Object (E) Total	23,090,772.00	21,184,936.65	2,232,894.46	0.00	1,905,835.35	92

Date: 07/12/18

Time: 20:31:19

Ending Date: 06/30/18

Shaler Area School District
2017-2018

Expenditure Accounts - with Activity Only

OBJECT SUPPLEMENT

	Adjusted Budget	YTD Expended	Current Expended	Current Encumbrances	Remaining Balance	Used
ALL						
10 Fund 10						
300 Purchased Prof/tech Svc						
322 Prof Education Serv-iu	771,650.00	441,317.05	50,636.03	11,776.28	318,556.67	59
323 Professional Educational	0.00	296,143.60	28,317.63	0.00	-296,143.60	-999
324 Conference Training	15,400.00	72,970.97	5,020.00	12,770.00	-70,340.97	557
329 Professional Educational	0.00	24,432.50	3,857.50	0.00	-24,432.50	-999
330 Purch Other Prof Svc	1,308,374.00	379,029.50	20,763.58	11,133.58	918,211.00	30
332 Delinquent	0.00	35,212.14	1,996.02	0.00	-35,212.14	-999
333 Tax Appeal-legal	0.00	24,038.20	5,360.00	0.00	-24,038.20	-999
334 Tax Collection Fees -bp	0.00	21,174.50	0.00	0.00	-21,174.50	-999
335 Tax Collection Fees-cs	0.00	2,197.90	2,197.90	0.00	-2,197.90	-999
340 Purch Technical Svc	3,360.00	2,534.00	0.00	0.00	826.00	75
350 Security/safety Services	103,115.77	162,795.84	47,962.34	0.00	-59,680.07	158
390 Purch Other Prof Svc	3,398.05	3,398.00	0.00	0.05	0.00	100
300 Object (E) Total	2,205,297.82	1,465,244.20	166,111.00	35,679.83	704,373.79	68
400 Purchased Property Svc						
410 Cleaning Services	5,750.00	5,429.30	2,305.15	0.00	320.70	94
411 Disposal Services	57,709.00	39,664.09	3,536.39	16,427.59	1,617.32	97
415 Laundry/linen Svc/dry Cl	263.00	0.00	0.00	0.00	263.00	0
422 Electricity	865,000.00	925,053.63	66,336.91	0.00	-60,053.63	107
424 Water & Sewage	146,000.00	131,546.82	15,490.56	0.00	14,453.18	90
430 Repairs/maintenance	307,317.49	268,743.23	31,281.88	26,723.97	11,850.29	96
433 Repairs & Maintenance Srvc	31,915.39	32,044.39	1,557.38	1,353.11	-1,482.11	105
434 MAINT. REPAIRS KITCHEN	47,596.95	21,402.09	2,743.10	2,780.00	23,414.86	51
438 Maint&repair Infor Tech	52,146.00	39,897.01	1,294.95	2,866.00	9,382.99	82
440 Rentals	2,876.00	0.00	0.00	0.00	2,876.00	0
442 Rental-equip&vehicles	113,356.82	146,822.33	16,401.66	13,985.25	-47,450.76	142
443 Rental-Capital Equip	4,000.00	0.00	0.00	0.00	4,000.00	0
400 Object (E) Total	1,633,930.65	1,610,602.89	140,947.98	64,135.92	-40,808.16	103
500 Other Purchased Services						
510 Student Transport Svc	296,532.10	155,694.38	28,731.17	157.18	140,680.54	53
513 Stdnt Tran Svcc-cont	4,946,000.00	4,436,211.33	522,117.94	0.00	509,788.67	90
515 Stdnt Tran Svcc-public	500.00	503.50	112.50	0.00	-3.50	101
516 Stdnt Tran Svcc-iu	85,000.00	245.26	245.26	0.00	84,754.74	0
521 Blanket Insurance	195,000.00	160,063.00	0.00	0.00	34,937.00	82

Date: 07/12/18

Time: 20:31:19

Ending Date: 06/30/18

Shaler Area School District

2017-2018

Page: 3

BAR020A

Expenditure Accounts - with Activity Only

OBJECT SUPPLEMENT

	Adjusted Budget	YTD Expended	Current Expended	Current Encumbrances	Remaining Balance	Used
ALL						
10 Fund 10						
500 Other Purchased Services						
522 Auto Liability Ins	17,000.00	6,783.00	0.00	0.00	10,217.00	40
523 General Prop/liab Ins	36,000.00	9,906.00	0.00	0.00	26,094.00	28
524 Insurance Deductibles	25,000.00	0.00	0.00	0.00	25,000.00	0
525 Bonding Insurance	12,000.00	11,456.11	0.00	0.00	543.89	95
529 Umbrella Insurance	30,000.00	22,900.00	0.00	0.00	7,100.00	76
530 Communications	51,000.00	36,846.99	9,883.67	0.00	14,153.01	72
538 Transport/telecommunications	73,000.00	77,454.84	7,708.61	818.00	-5,272.84	107
549 ADVERTISING	15,000.00	4,917.62	980.20	0.00	10,082.38	33
561 Tuition/lea W/i State	651,000.00	69,557.26	533.36	0.00	581,442.74	11
562 Tuition Payments To Charter	1,350,000.00	898,871.55	174,092.73	0.00	451,128.45	67
563 Tuition/private Sch	114,250.00	84,908.41	8,483.99	0.00	29,341.59	74
564 Tuition To Avts	1,332,000.00	1,472,739.05	0.00	0.00	-140,739.05	111
566 Tuition To Comm. Coll. & Tech	10,000.00	45,073.12	0.00	0.00	-35,073.12	451
567 Tuition To Appr Priv Sch (APS)	825,000.00	1,067,113.89	773,052.01	0.00	-242,113.89	129
568 Tuition-PA Priv Res Reh Inst	351,750.00	233,972.50	71,635.41	1,600.00	116,177.50	67
569 Tuition - Other	31,500.00	3,200.00	0.00	0.00	28,300.00	10
580 Travel	32,115.97	15,462.80	795.63	0.00	16,653.17	48
581 Travel Conference	12,111.31	15,977.44	2,974.96	535.17	-4,401.30	136
582 Travel Teachers Inter District	2,000.00	4,397.74	1,559.71	0.00	-2,397.74	220
583 Travel w/students	1,926.94	5,391.11	1,567.25	0.00	-3,464.17	280
584 Travel Inter-District	11,919.61	9,729.97	2,687.02	0.00	2,189.64	82
590 Misc Purchased Services	1,575.00	1,176.47	0.00	323.53	75.00	95
591 Security/police Svc	68,598.96	27,433.16	3,712.14	0.00	41,165.80	40
594 Svc Purch From Iu-spec	0.00	16,910.74	16,910.74	0.00	-16,910.74	-999
595 Iu Payments/withheld	61,425.00	61,369.51	0.00	0.00	55.49	100
598 Camp Food Service	2,250.00	1,370.91	0.00	0.00	879.09	61
599 Misc Purchased Services	57,799.56	48,742.24	3,891.41	199.00	8,858.32	85
500 Object (E) Total	10,699,254.45	9,006,379.90	1,631,675.71	3,632.88	1,689,241.67	84
600 Supplies						
610 General Supplies	867,804.16	576,092.14	29,032.15	155,767.27	135,944.75	84
611 Uniforms	24,308.51	25,149.24	683.70	861.40	-1,702.13	107
617 Supplies	120,000.00	35,968.80	0.00	0.00	84,031.20	30
618 Software, Supplies & Licensing	431,940.00	358,123.44	3,441.87	17,968.73	55,847.83	87
621 Natural Gas	266,000.00	282,834.02	10,742.09	0.00	-16,834.02	106
626 Gasoline	55,000.00	28,969.88	-14,907.30	0.00	26,030.12	53

Date: 07/12/18
 Time: 20:31:19
 Ending Date: 06/30/18

Shaler Area School District
 2017-2018

Expenditure Accounts - with Activity Only

OBJECT SUPPLEMENT

	Adjusted Budget	YTD Expended	Current Expended	Current Encumbrances	Remaining Balance	Used
ALL						
10 Fund 10						
600 Supplies						
635 Meals / Refreshments	0.00	1,932.73	0.00	0.00	-1,932.73	-999
640 Books	497,802.00	299,837.75	5,314.68	128,649.30	69,314.95	86
641 Periodicals	0.00	36.30	0.00	0.00	-36.30	-999
648 Books&periodicals On Elec	49,500.00	48,863.73	509.40	467.53	168.74	100
600 Object (E) Total	2,312,354.67	1,657,808.03	34,816.59	303,714.23	350,832.41	85
700 Property						
750 Equip-original & Addl	250,255.27	181,694.66	3,703.45	8,546.49	60,014.12	76
751 Non-capital Equipment -	9,502.69	6,395.85	1,373.88	2,888.94	217.90	98
752 Capital Equipment - Original	21,288.20	34,218.20	0.00	0.00	-12,930.00	161
754 Capital Equipment - Food	15,000.00	0.00	0.00	0.00	15,000.00	0
758 Capital New Hardware Software	123,385.00	62,797.23	710.87	485.64	60,102.13	51
760 Equipment-replacement	88,332.50	18,849.19	1,127.44	125.55	69,357.76	21
761 Non-capital Equipment	14,369.32	1,693.81	433.83	4,374.78	8,300.73	42
763 Capital Vehicles	0.00	0.00	0.00	0.00	0.00	-999
764 Capital Equipment Food Service	19,500.00	2,000.00	0.00	2,500.00	15,000.00	23
768 Capital Eq Harware Software	38,800.00	9,340.80	0.00	284.59	29,174.61	25
700 Object (E) Total	580,432.98	316,989.74	7,349.47	19,205.99	244,237.25	58
800 Other Objects						
810 Dues & Fees	71,657.53	51,770.78	15,350.29	4,374.50	15,512.25	78
831 Interest-loan/lease Agr	14,647.00	0.00	0.00	0.00	14,647.00	0
838 INTEREST - LEASE	0.00	4,646.96	0.00	0.00	-4,646.96	-999
839 Interest-other Obligations	67,439.00	0.00	0.00	0.00	67,439.00	0
860 Grants-community Svc	9,500.00	26,388.58	0.00	0.00	-16,888.58	278
880 Refund/prior Yr Recpt	125,000.00	26,952.40	0.00	0.00	98,047.60	22
800 Object (E) Total	288,243.53	109,758.72	15,350.29	4,374.50	174,110.31	40
900 Other Financing Uses						
910 Redemption Of Principal	25,000.00	121,137.53	0.00	0.00	-96,137.53	485
911 Lease Pmts/principle	243,798.00	17,939.61	0.00	0.00	225,858.39	7
930 Fund Transfers	7,034,642.00	7,104,699.20	6,061.74	0.00	-70,057.20	101
900 Object (E) Total	7,303,440.00	7,243,776.34	6,061.74	0.00	59,663.66	99
10 Fund (E) Total	83,836,735.00	74,623,750.94	7,996,959.75	430,743.35	8,782,240.71	90
Report Totals	83,836,735.00	74,623,750.94	7,996,959.75	430,743.35	8,782,240.71	90

Date: 07/12/18

Time: 20:30:31

Ending Date: 06/30/18

Shaler Area School District

2017-2018

Page: 1

BAR020A

Revenue Accounts - with Activity Only

Revenues Board Supplement

	Anticipated Revenue	Adjustments	YTD Revenue Received	Current Revenue Received	Remaining Balance	Used
ALL						
10 Fund 10						
6000 Revenue - Local Sources						
6111 Cur Real Estate Tax						
001 Etna	2,327,287.00	0.00	2,381,362.73	0.00	-54,075.73	102
002 Millvale	1,888,176.00	0.00	1,766,157.74	15,945.98	122,018.26	93
003 Reserve	3,205,508.00	0.00	3,192,846.58	5,391.10	12,661.42	99
004 Shaler	36,523,555.00	0.00	37,235,724.08	256,014.71	-712,169.08	101
6111 Function (R) Total	43,944,526.00	0.00	44,576,091.13	277,351.79	-631,565.13	101
6113 Public Utility Realty Tx						
000 TO BE DISTRIBUTED	54,000.00	0.00	49,843.08	0.00	4,156.92	92
6113 Function (R) Total	54,000.00	0.00	49,843.08	0.00	4,156.92	92
6143 Cur Act 511 Opt Tax						
001 Etna	4,000.00	0.00	3,630.55	0.00	369.45	90
002 Millvale	3,000.00	0.00	4,992.49	0.00	-1,992.49	166
003 Reserve	500.00	0.00	788.68	0.00	-288.68	157
004 Shaler	12,680.00	0.00	17,084.04	2,094.62	-4,404.04	134
6143 Function (R) Total	20,180.00	0.00	26,495.76	2,094.62	-6,315.76	131
6151 Cur Earned Income Tax						
001 Etna	327,000.00	0.00	336,654.88	77,715.33	-9,654.88	102
002 Millvale	316,000.00	0.00	323,683.83	71,800.51	-7,683.83	102
003 Reserve	348,000.00	0.00	419,037.26	91,509.30	-71,037.26	120
004 Shaler	4,109,000.00	0.00	3,546,379.48	359,687.77	562,620.52	86
6151 Function (R) Total	5,100,000.00	0.00	4,625,755.45	600,712.91	474,244.55	90
6153 Real Estate Transfers						
000 TO BE DISTRIBUTED	403,600.00	0.00	514,049.56	66,821.31	-110,449.56	127
6153 Function (R) Total	403,600.00	0.00	514,049.56	66,821.31	-110,449.56	127
6411 Del Real Estate Tax						
001 Etna	150,000.00	0.00	183,961.32	40,825.81	-33,961.32	122
002 Millvale	150,000.00	0.00	250,446.13	17,370.12	-100,446.13	166
003 Reserve	150,000.00	0.00	196,469.20	39,607.70	-46,469.20	130
004 Shaler	1,014,500.00	0.00	1,409,739.93	128,343.88	-395,239.93	138
6411 Function (R) Total	1,464,500.00	0.00	2,040,616.58	226,147.51	-576,116.58	139

Date: 07/12/18
 Time: 20:30:31
 Ending Date: 06/30/18

Shaler Area School District
 2017-2018
 Revenue Accounts - with Activity Only

Revenues Board Supplement

	Anticipated Revenue	Adjustments	YTD Revenue Received	Current Revenue Received	Remaining Balance	Used
ALL						
10 Fund 10						
6000 Revenue - Local Sources						
6451 Del Earned Income Tax						
002 Millvale	15,000.00	0.00	5,241.35	25.57	9,758.65	34
003 Reserve	1,000.00	0.00	10,637.95	0.00	-9,637.95	1063
004 Shaler	29,000.00	0.00	0.00	0.00	29,000.00	0
6451 Function (R) Total	45,000.00	0.00	15,879.30	25.57	29,120.70	35
6510 Earnings On Investments						
000 TO BE DISTRIBUTED	60,270.00	0.00	316,547.89	30,936.55	-256,277.89	525
6510 Function (R) Total	60,270.00	0.00	316,547.89	30,936.55	-256,277.89	525
6710 Admission-student Events						
000 TO BE DISTRIBUTED	51,000.00	0.00	53,399.66	0.00	-2,399.66	104
6710 Function (R) Total	51,000.00	0.00	53,399.66	0.00	-2,399.66	104
6740 Athletic Physicals						
000 TO BE DISTRIBUTED	1,500.00	0.00	1,250.00	700.00	250.00	83
6740 Function (R) Total	1,500.00	0.00	1,250.00	700.00	250.00	83
6832 IDEA Federal Pass Through						
000 TO BE DISTRIBUTED	850,000.00	0.00	6,144.00	6,144.00	843,856.00	0
6832 Function (R) Total	850,000.00	0.00	6,144.00	6,144.00	843,856.00	0
6890 Other Revenue From						
000 TO BE DISTRIBUTED	0.00	0.00	204,500.55	18,562.74	-204,500.55	-999
6890 Function (R) Total	0.00	0.00	204,500.55	18,562.74	-204,500.55	-999
6910 Rentals						
005 Athletic Fields	12,000.00	0.00	35,634.25	19,414.25	-23,634.25	296
006 Classrooms	18,000.00	0.00	14,380.00	2,380.00	3,620.00	79
007 Gymnasiums	0.00	0.00	9,252.36	3,468.75	-9,252.36	-999
6910 Function (R) Total	30,000.00	0.00	59,266.61	25,263.00	-29,266.61	197
6920 Contrib. & Donations From						
000 TO BE DISTRIBUTED	29,089.00	0.00	19,019.00	0.00	10,070.00	65
6920 Function (R) Total	29,089.00	0.00	19,019.00	0.00	10,070.00	65

Date: 07/12/18
 Time: 20:30:32
 Ending Date: 06/30/18

Shaler Area School District
 2017-2018
 Revenue Accounts - with Activity Only

Revenues Board Supplement

	Anticipated Revenue	Adjustments	YTD Revenue Received	Current Revenue Received	Remaining Balance	Used
ALL						
10 Fund 10						
6000 Revenue - Local Sources						
6942 Summer School Tuition						
000 TO BE DISTRIBUTED	0.00	0.00	20,455.00	0.00	-20,455.00	-999
6942 Function (R) Total	0.00	0.00	20,455.00	0.00	-20,455.00	-999
6980 Rev From Community Act						
000 TO BE DISTRIBUTED	32,000.00	0.00	38,170.25	776.00	-6,170.25	119
095 Fitness Program	25,513.00	0.00	5,992.00	0.00	19,521.00	23
6980 Function (R) Total	57,513.00	0.00	44,162.25	776.00	13,350.75	76
6991 Refunds						
000 TO BE DISTRIBUTED	0.00	0.00	38,464.33	22,320.00	-38,464.33	-999
6991 Function (R) Total	0.00	0.00	38,464.33	22,320.00	-38,464.33	-999
6999 All Other Revenues Not						
000 TO BE DISTRIBUTED	18,000.00	0.00	27,632.32	2,269.88	-9,632.32	153
6999 Function (R) Total	18,000.00	0.00	27,632.32	2,269.88	-9,632.32	153
6000 Function (R) Total	52,129,178.00	0.00	52,639,572.47	1,280,125.88	-510,394.47	100
7000 Revenue - State Sources						
7110 Basic Instr Subsidies						
000 TO BE DISTRIBUTED	11,228,110.00	0.00	11,324,285.30	3,622,221.89	-96,175.30	100
7110 Function (R) Total	11,228,110.00	0.00	11,324,285.30	3,622,221.89	-96,175.30	100
7160 1305 & 1306 Tuition						
000 TO BE DISTRIBUTED	70,000.00	0.00	25,797.31	25,797.31	44,202.69	36
7160 Function (R) Total	70,000.00	0.00	25,797.31	25,797.31	44,202.69	36
7271 Sp Ed-reg Progrm						
000 TO BE DISTRIBUTED	3,399,197.00	0.00	2,984,161.73	869,915.66	415,035.27	87
7271 Function (R) Total	3,399,197.00	0.00	2,984,161.73	869,915.66	415,035.27	87
7310 Subsidy/transportation						
000 TO BE DISTRIBUTED	1,780,000.00	0.00	0.00	0.00	1,780,000.00	0
7310 Function (R) Total	1,780,000.00	0.00	0.00	0.00	1,780,000.00	0

Date: 07/12/18
 Time: 20:30:32
 Ending Date: 06/30/18

Shaler Area School District
 2017-2018
 Revenue Accounts - with Activity Only

Revenues Board Supplement

	Anticipated Revenue	Adjustments	YTD Revenue Received	Current Revenue Received	Remaining Balance	Used
ALL						
10 Fund 10						
7000 Revenue - State Sources						
7311 TRANSPORTATION						
000 TO BE DISTRIBUTED	0.00	0.00	1,413,242.47	92,247.47	-1,413,242.47	-999
7311 Function (R) Total	0.00	0.00	1,413,242.47	92,247.47	-1,413,242.47	-999
7312 TRANSPORTATION SUB						
000 TO BE DISTRIBUTED	0.00	0.00	148,995.00	74,497.00	-148,995.00	-999
7312 Function (R) Total	0.00	0.00	148,995.00	74,497.00	-148,995.00	-999
7320 Subsidy/rental & Sf Pmt						
000 TO BE DISTRIBUTED	300,000.00	0.00	-158,740.50	0.00	458,740.50	-52
7320 Function (R) Total	300,000.00	0.00	-158,740.50	0.00	458,740.50	-52
7330 Subs/medical & Dental						
000 TO BE DISTRIBUTED	85,000.00	0.00	-84,780.87	0.00	169,780.87	-99
7330 Function (R) Total	85,000.00	0.00	-84,780.87	0.00	169,780.87	-99
7340 Property Tax Relief Pmt						
000 TO BE DISTRIBUTED	2,040,513.00	0.00	2,040,512.82	0.00	0.18	100
7340 Function (R) Total	2,040,513.00	0.00	2,040,512.82	0.00	0.18	100
7360 Safe Schools						
000 TO BE DISTRIBUTED	0.00	0.00	-10,000.00	0.00	10,000.00	-999
7360 Function (R) Total	0.00	0.00	-10,000.00	0.00	10,000.00	-999
7505 READY TO LEARN GRANT						
000 TO BE DISTRIBUTED	706,470.00	0.00	706,471.00	0.00	-1.00	100
7505 Function (R) Total	706,470.00	0.00	706,471.00	0.00	-1.00	100
7810 Social Security Subsidy						
000 TO BE DISTRIBUTED	1,360,892.00	0.00	770,776.95	0.00	590,115.05	56
7810 Function (R) Total	1,360,892.00	0.00	770,776.95	0.00	590,115.05	56
7820 Retirement Subsidy						
000 TO BE DISTRIBUTED	6,008,978.00	0.00	3,922,852.85	1,608,377.55	2,086,125.15	65

Date: 07/12/18

Time: 20:30:32

Ending Date: 06/30/18

Shaler Area School District
2017-2018

Page: 5
BAR020A

Revenue Accounts - with Activity Only

Revenues Board Supplement

	Anticipated Revenue	Adjustments	YTD Revenue Received	Current Revenue Received	Remaining Balance	Used
ALL						
10 Fund 10						
7820 Function (R) Total	6,008,978.00	0.00	3,922,852.85	1,608,377.55	2,086,125.15	65
7000 Function (R) Total	26,979,160.00	0.00	23,083,574.06	6,293,056.88	3,895,585.94	85
8000 Revenue - Federal Source						
8514 Nclb-title I-improving						
000 TO BE DISTRIBUTED	600,000.00	0.00	217,520.61	41,438.57	382,479.39	36
8514 Function (R) Total	600,000.00	0.00	217,520.61	41,438.57	382,479.39	36
8515 Nclb-title Ii-preparing						
000 TO BE DISTRIBUTED	140,000.00	0.00	28,687.71	0.00	111,312.29	20
8515 Function (R) Total	140,000.00	0.00	28,687.71	0.00	111,312.29	20
8516 Title I Program Improvement						
000 TO BE DISTRIBUTED	0.00	0.00	1,072.40	0.00	-1,072.40	-999
8516 Function (R) Total	0.00	0.00	1,072.40	0.00	-1,072.40	-999
8517 Nclb-title Iv-21st Century Sch						
000 TO BE DISTRIBUTED	0.00	0.00	929.50	0.00	-929.50	-999
8517 Function (R) Total	0.00	0.00	929.50	0.00	-929.50	-999
8690 Other Restricted Fed						
000 TO BE DISTRIBUTED	0.00	0.00	500.00	0.00	-500.00	-999
8690 Function (R) Total	0.00	0.00	500.00	0.00	-500.00	-999
8810 Medical Assistance-access						
000 TO BE DISTRIBUTED	200,000.00	0.00	283,304.61	0.00	-83,304.61	141
8810 Function (R) Total	200,000.00	0.00	283,304.61	0.00	-83,304.61	141
8820 Medical Assistance-title 19						
000 TO BE DISTRIBUTED	0.00	0.00	-6,606.06	0.00	6,606.06	-999
8820 Function (R) Total	0.00	0.00	-6,606.06	0.00	6,606.06	-999
8000 Function (R) Total	940,000.00	0.00	525,408.77	41,438.57	414,591.23	55
9000 Other Financing Sources						
9990 Insurance Recoveries						
000 TO BE DISTRIBUTED	0.00	0.00	1,087.02	1,087.02	-1,087.02	-999
9990 Function (R) Total	0.00	0.00	1,087.02	1,087.02	-1,087.02	-999

Date: 07/12/18
 Time: 20:30:32
 Ending Date: 06/30/18

Shaler Area School District
 2017-2018
 Revenue Accounts - with Activity Only

Revenues Board Supplement

	Anticipated Revenue	Adjustments	YTD Revenue Received	Current Revenue Received	Remaining Balance	%Used
ALL						
10 Fund 10						
9000 Other Financing Sources						
9999 Fund Balance						
000 TO BE DISTRIBUTED	3,788,397.00	0.00	0.00	0.00	3,788,397.00	0
9999 Function (R) Total	3,788,397.00	0.00	0.00	0.00	3,788,397.00	0
9000 Function (R) Total	3,788,397.00	0.00	1,087.02	1,087.02	3,787,309.98	0
10 Fund (R) Total	83,836,735.00	0.00	76,249,642.32	7,615,708.35	7,587,092.68	90
Report Totals	83,836,735.00	0.00	76,249,642.32	7,615,708.35	7,587,092.68	90

Date:07/12/18

Time:20:09:40

Transaction Detail Report For 2017-2018

Shaler Area School District

Transaction Detail

Budget Transfers

Page: 1

BAR017

Date Range 06/30/18-08/31/18

Account Number	Voucher#	Description / Vendor	Date	SRC	PO#	Invoice#	Check#	Amount
121156130 / 10-1211.561.000.30.00	10	BT JUNE TRANSFER TO 124175010 PER SL/KG	06/30/18	BT				-42,000.00
124175010 / 10-1241.750.000.10.00	10	BT JUNE FROM 124175010 PER SL/KG	06/30/18	BT				42,000.00
Totals For Fund 10 Fund 10						2 Transaction Lines Totaling		0.00
Total Debits		42,000.00	Total Credits					-42,000.00

**SHALER AREA SCHOOL DISTRICT
FUND PROFILES & INVESTMENTS
Jun-18**

GENERAL FUND

Beginning Balance June 1, 2018		\$16,391,029.72
Receipts	\$6,693,222.04	
Disbursements	\$8,935,808.35	
Ending Balance June 30, 2018		\$14,148,443.41

SUMMARY OF INVESTMENTS - GENERAL FUND

<i>Financial Institution</i>	<i>Investment Type</i>	<i>Interest Rate</i>	<i>Maturity</i>	<i>Amount</i>
PSDLAF	MAX	1.43%	LIQUID	\$1,580,693.35
PSDLAF	MAX	1.43%	LIQUID	\$179,447.97
PSDLAF	FLEX	1.95%	LIQUID	\$9,500,000.00
PLGIT	CLASS	1.15%	LIQUID	\$256,620.39
PLGIT	I - CLASS	1.30%	LIQUID	\$1,830,327.58
PLGIT	PLUS	1.26%	LIQUID	\$6,520.89
PLGIT	CD	1.60%	7/11/2018	\$246,000.00
PLGIT	CD	1.60%	7/11/2018	\$246,000.00
PLGIT	CD	1.60%	7/11/2018	\$246,000.00
PLGIT	CD	1.87%	8/8/2018	\$247,000.00
PLGIT	CD	1.85%	8/8/2018	\$247,000.00
Total				\$14,585,610.18

FUND PROFILES & INVESTMENTS

Jun-18

Page 2

FUND FOR CONSTRUCTION, RENOVATION & REPAIR (CR&R)

Beginning Balance June 1, 2018		\$345,463.49
Receipts	\$449.57	
Disbursements	\$0.00	
Ending Balance June 30, 2018		\$345,913.06

<i>Financial Institution</i>	<i>Investment Type</i>	<i>Interest Rate</i>	<i>Maturity</i>	<i>Amount</i>
PSDLAF	MAX	1.10%	LIQUID	\$345,913.06
TOTAL				\$343,463.49

CAFETERIA FUND

Beginning Balance June 1, 2018		\$70,962.18
Receipts	\$112,439.83	
Disbursements	\$0.00	
Ending Balance June 30, 2018		\$183,402.01

<i>Financial Institution</i>	<i>Investment Type</i>	<i>Interest Rate</i>	<i>Maturity</i>	<i>Amount</i>
PSDLAF	MAX	1.43%	LIQUID	\$184,256.67
Total				\$184,256.67

FUND PROFILES & INVESTMENTS

Jun-18

Page 3

BOND FUND

Beginning Balance June 1, 2018		\$6,417,637.62
Receipts	\$10,093.78	
Disbursements	\$1,041,951.98	
Ending Balance June 30, 2018		\$5,385,779.42

SUMMARY OF INVESTMENTS - BOND FUND

<i>Financial Institution</i>	<i>Investment Type</i>	<i>Interest Rate</i>	<i>Maturity</i>	<i>Amount</i>
PSDLAF	FLEX	1.43%	LIQUID	\$385,753.40
PSDLAF	FLEX	1.58%	LIQUID	\$25.82
PSDLAF	FLEX	1.58%	LIQUID	\$0.20
PSDLAF	FLEX	2.05%	LIQUID	\$3,000,000.00
PSDLAF	FLEX	2.10%	LIQUID	\$2,000,000.00
Total				\$5,385,779.42

Supplement C.2 – Cafeteria Operating Statement May

	May <u>2018</u>	YTD <u>2018</u>	May <u>2017</u>	YTD <u>2017</u>	Change <u>From 2017</u>
<u>Operating Income:</u>					
Breakfast Sales	6,005.25	40,329.00	4,244.40	31,472.55	8,856.45
Lunch Sales	54,629.40	479,818.00	56,741.45	483,041.70	(3,223.70)
Ala Carte Sales	36,845.65	361,145.51	38,578.60	366,471.50	(5,325.99)
Special Function Sales	10,511.90	72,922.83	11,387.18	75,454.12	(2,531.29)
Total Operating Income	107,992.20	954,215.34	110,951.63	956,439.87	(2,224.53)
<u>Operating Expenses:</u>					
Salaries & Benefits	99,892.41	861,170.20	98,952.48	863,933.03	(2,762.83)
Budgeted Other Cost	18,329.55	204,745.32	14,914.60	165,406.76	39,338.56
Food	73,313.34	687,238.64	81,191.72	676,657.91	10,580.73
Paper & Cleaning	6,341.22	70,234.38	5,026.11	68,448.93	1,785.45
PTO Day Accrual	2,000.00	18,000.00	2,000.00	18,000.00	-
Total Operating Expenses	199,876.52	1,841,388.54	202,084.91	1,792,446.63	48,941.91
L4L Credit Labor Credit				(20,638.83)	20,638.83
Net Operating Income (Loss)	(91,884.32)	(887,173.20)	(91,133.28)	(815,367.93)	(71,805.27)
<u>Non-Operating Income:</u>					
Federal & State Subsidy	100,997.67	871,938.99	99,199.59	840,702.16	31,236.83
Actual Net Income (Loss)	9,113.35	(15,234.21)	8,066.31	25,334.23	(40,568.44)
<u>Breakfast Serving Days</u>					
Breakfasts Served Days	21	177	21	176	1
Breakfasts Served	12,465	91,855	10,471	80,994	10,861
Average Brk/ Day	594	519	499	460	59
<u>Lunch Serving Days</u>					
Lunches Served Days	21	178	21	177	1
Lunches Served	44,948	395,089	46,194	395,523	(434)
Average Lunches per Day	2,140	2,220	2,200	2,235	(15)
<u>Ala Carte Sales Days</u>					
Ala Carte Sales Days	21	178	21	177	1
Ala Carte Sales	36,845.65	361,145.51	38,578.60	366,471.50	(5,326)
Average Ala Carte per Day	1,755.00	2,028.91	1,837.00	2,070.00	(41)

MITCH STIVASON
Coordinator of Technology

SHALER AREA SCHOOL DISTRICT
Technology Department

1800 Mt. Royal Boulevard
Glenshaw, Pennsylvania 15116

Phone (412) 492-1200 ext. 2875
FAX (412) 684-0042

www.sasd.k12.pa.us

JENNIFER TONG, PH.D
Network Administrator

THOMAS WYANT
*Data Processing Operations
Specialist*

INTER-OFFICE MEMO

TO: Ms. Sherri Ludwig, Director of Business Affairs
CC: Mrs. Susan McElhinny, Administrative Assistant
FROM: Mr. Mitch Stivason
DATE: Monday, July 16, 2018
RE: Recycling of Technology Equipment

The following technology equipment is no longer of any use to the students or staff of Shaler Area School District. We recommend disposal of this equipment. The computers/laptops/printers etc. are not repairable and will be recycled through JVS Environmental at no cost to the district.

22	Unusable Monitors
1	Unusable NCS desktop computers
48	Unusable Dell desktop computer
2	VHS Players
15	Laptop Batteries
8	Unusable Television
25	Unusable Lenovo Laptops
2	Unusable Projectors (Mitsubishi)
37	Unusable overhead projectors
3	DVD/VCR players



June 27, 2018

NOTICE
Tri-COG Land Bank Proposed Property Acquisitions
Objection Deadline: August 26, 2018
SECTION 7.3 Intergovernmental Cooperation Agreement

Ms. April Kwiatkowski
Shaler Area School District
1800 Mt Royal Blvd
Glenshaw, PA 15116

Dear Ms. Kwiatkowski:

The Tri Cog Land Bank ("TCLB") intends to acquire the following properties within the Shaler Area School District:

Address	Lot Block	Municipality
27 Freeport Street, Pittsburgh, PA 15223	167-F-134	Etna

If, within sixty (60) days of this notice, the governing body of a School District notifies the Land Bank, in writing, that it objects to the acquisition by a Super Majority vote, the Land Bank shall not acquire said Real Property.

Please note, the properties proposed for acquisition may be subject to judicial tax enforcement proceedings by the TCLB or a Land Bank Member and may be acquired by the Land Bank at judicial sale for a bid no greater than the Plaintiff's costs, fees, expenses and attorney fees as provided for by the ICA.

Pursuant to §2117 of the Land Bank Act, Land Bank Members are permitted to waive all taxes, tax claims and municipal claims due and owing at the time that the property is acquired by the TCLB. All properties acquired by the TCLB, regardless of bid amount, shall be free and clear of all taxes, tax claims and municipal claims and all such liens shall be satisfied of record following the TCLB's acquisition of properties subject to such liens.

If you have any questions, please contact me immediately.

Sincerely,

A handwritten signature in black ink, appearing to read "An Lewis", is written over a light gray background.

An Lewis
Executive Director
Tri-COG Land Bank



0167F00134000000

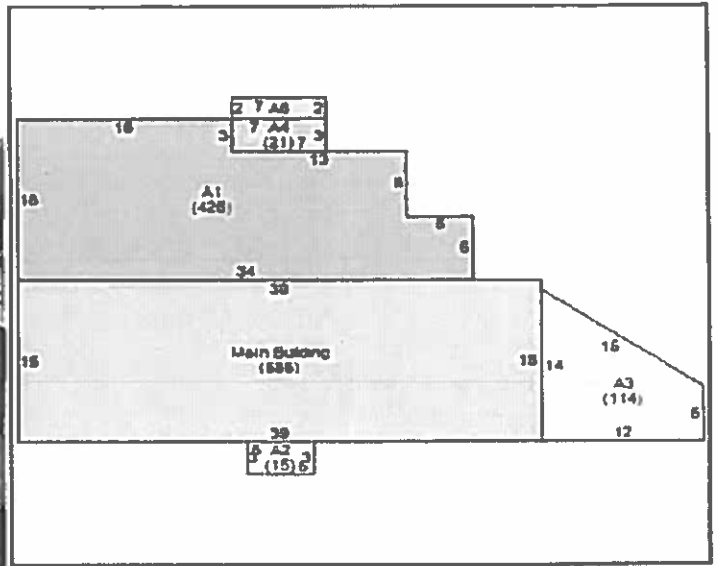

A1	Full Basement (conv main bldg) 1 story masonry Upper story frame	426 Sq. Ft.
Main Building		585 Sq. Ft.
A3	Full Basement (conv main bldg) 1 story masonry	114 Sq. Ft.
A4	Full Basement (conv main bldg) 1 story masonry	21 Sq. Ft.
A6	Canopy Over Patio	14 Sq. Ft.
A2	Stoop Masonry	15 Sq. Ft.

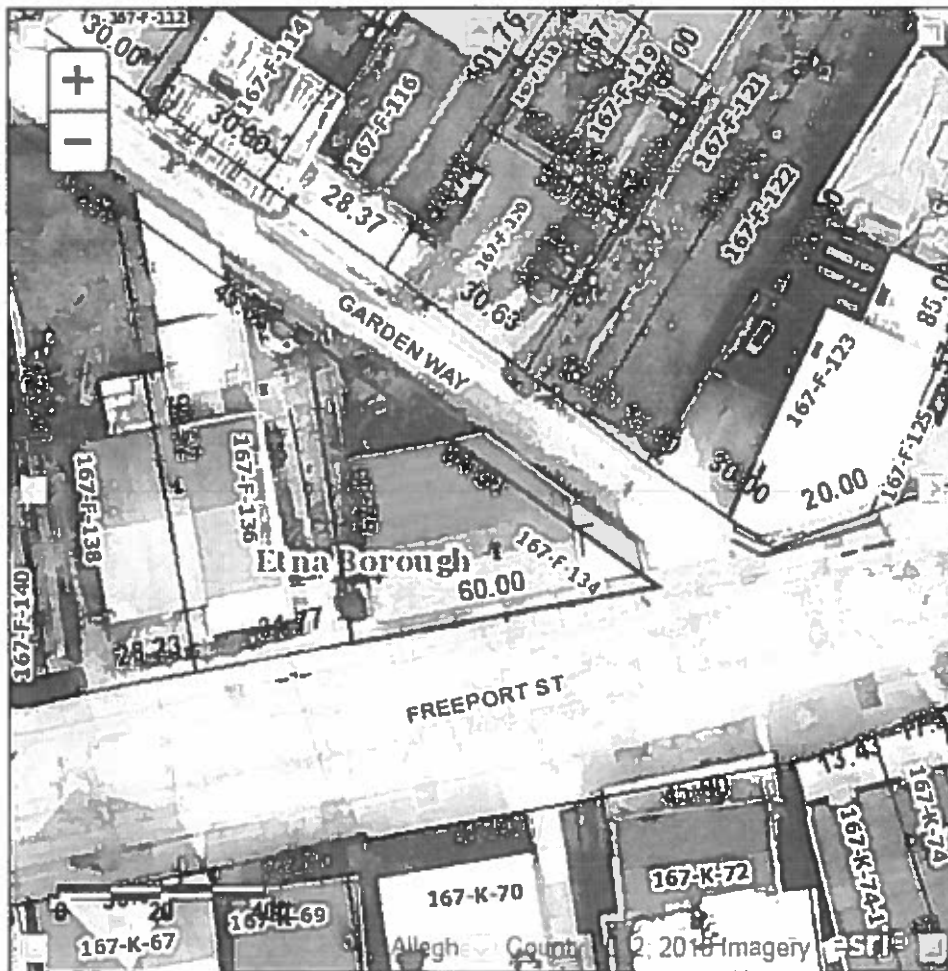

SALE AND PURCHASE AGREEMENT

THIS SALE AND PURCHASE AGREEMENT (this "Agreement") is made as of the 18th day of July, 2018 ("Agreement Date") by and between MOUNT ALVERNIA DAY CARE AND LEARNING CENTER, 146 Hawthorne Road, Pittsburgh, Pennsylvania 15209 (hereinafter referred to as "Purchaser"), and the SHALER AREA SCHOOL DISTRICT, a political subdivision of the Commonwealth of Pennsylvania, having its administrative offices located at 1800 Mt. Royal Blvd., Glenshaw, Pennsylvania 15116, (hereinafter, the "Seller").

WITNESSETH:

WHEREAS, Seller is the owner of a parcel of real property located in the Township of Shaler, County of Allegheny, State of Pennsylvania known as and by the street address of 201 Wetzel Road, Glenshaw, Pennsylvania 15116 as more particularly described on Exhibit "A" attached hereto and incorporated by reference (the "Real Property") and the buildings and improvements thereon erected (the "Improvements"); and

WHEREAS, Purchaser desires to purchase from Seller the Real Property and Improvements together with such other properties as are hereinafter described in Paragraph 1 below in accordance with the terms and conditions hereinafter set forth.

NOW, THEREFORE, for and in consideration of the mutual promises, covenants and conditions hereinafter set forth, and other good and valuable consideration, the receipt and sufficiency of which are hereby acknowledged, Purchaser and Seller hereby covenant and agree as follows:

1. **Property.** Subject to the terms and conditions of this Agreement, Seller agrees to sell to Purchaser and Purchaser agrees to purchase from Seller all of the following described property (collectively, the "Property"):

(a) The Real Property (\pm 5.85 acres in size), together with all easements, rights-of-way and appurtenances used in connection with the beneficial use and enjoyment of the Real Property;

(b) The Improvements; and

(c) All right, title and interest of Seller, if any, in and to any streets, highways or rights of way adjacent to the Real Property and all right, title and interest of Seller, if any, in and to any award made or to be made in lieu thereof and in and to any unpaid award for damages to the Real Property by reason of change of grade of any street;

2. **Purchase Price.** The purchase price for the Property (the "**Purchase Price**") shall be the amount of SIX HUNDRED FIFTY THOUSAND and 00/100 (\$650,000.00) DOLLARS.

3. **Payment Terms.** The Purchase Price shall be payable as follows:

(a) A deposit in the amount of THIRTY THOUSAND and 00/100 (\$30,000.00) DOLLARS (the "**Deposit**") shall be paid in escrow to an acceptable title company ("**Escrow Agent**").

(b) The balance of the Purchase Price shall be payable cash or certified check at the Closing.

(c) In the event this Agreement does not close for any reason other than Purchaser's default, the Deposit will be paid by Escrow Agent to the Purchaser. If, however, this Agreement does not close due to Purchaser's default and such default is not cured within fifteen (15) days after written notice thereof from Seller, Escrow Agent shall deliver the Deposit to Seller as liquidated damages, actual damages in such event being difficult if not impossible to ascertain.

4. **Representations and Warranties.**

(a) Seller represents and warrants that:

(i) After diligent and complete investigation, all information and documentation heretofore furnished and made available to Purchaser by or on behalf of Seller with reference to the Property is true, complete and accurate to the best of Seller's knowledge. Seller knows of no facts or information which would make the foregoing representations inaccurate.

(ii) There are no service contracts, management agreements, equipment rental, employment, collective bargaining, union, or other contracts or agreements involving the Real Property which are in force and which will survive the Closing, except as set forth on Exhibit "B";

(iii) Seller owns unencumbered fee simple and marketable title to the Property free and clear of all restrictions, liens, encumbrances, easements, exceptions, chattel mortgages, conditional bills of sale, title retention contracts, Uniform Commercial Code Financing Statements, security interests of every kind or character, mechanics' and materialmen's liens, leases and tenant contracts, except for those matters of record or set forth in Exhibit "C" attached hereto and incorporated by reference herein (hereinafter called "**Permitted Exceptions**").

(iv) There is no pending claim, action, suit or proceeding pending or, to the best of Seller's knowledge threatened, affecting the property or Seller's ownership of the Property or any legal or beneficial ownership interest in Seller;

(v) Seller has full power and authority to enter into this Agreement and to assume and perform all of its obligations hereunder; the execution and delivery of this Agreement and the performance by Seller of its obligations hereunder have been duly authorized by such action as may be required and no further action or approval is required in order to constitute this Agreement as a binding and enforceable obligation of Seller; the execution and delivery of this Agreement and the consummation of the transactions contemplated hereunder on the part of the Seller does not and will not conflict with or result in the creation or imposition of any lien, charge or encumbrance upon any of the property or assets of Seller by reason of the terms of any contract, mortgage, lien, lease, agreement, indenture, instrument or judgment to which Seller is a party or which is or purports to be binding upon Seller or which affects Seller;

(vi) Seller shall not without Purchaser's prior written consent, which may be withheld in Purchaser's sole discretion, enter into any lease or occupancy agreement with respect to the Property;

(vii) There are no pending assessments and/or real estate taxes assessed and/or payable with respect to the Property. The Property is comprised of parcel identification numbers 354-M-53;

(viii) No governmental tax or other assessment, other than the lien of real estate taxes or its equivalent not yet due and payable, has been imposed against the Property which is unpaid; there are no special taxes or assessments applicable to the Property; and Seller has received no written notice and has no knowledge of any pending or contemplated proceeding or the construction of special improvements which would or might result in the levy of any special tax or assessment against the Property;

(ix) No person or entity has been engaged by or on behalf of Seller, whose engagement or action would entitle it to a fee or commission with respect to a prospective

lease, or the management or operation of the Property; and

(x) Seller shall not cause, suffer or permit the existence of any judgment, lien, mortgage, trust, deed, encumbrance or other cloud on or defect in title to the Property other than the lien of real estate taxes not yet due and payable which shall not be satisfied by Seller at or prior to Closing.

The foregoing representations, warranties, and agreements are true, correct and complete as of the date hereof (unless otherwise provided hereinabove), and shall be true, correct and complete as of the date and time of Closing. Seller shall notify Purchaser if any of the foregoing representations and warranties become untrue or change in any respect.

5. Conditions Precedent.

The obligation of Purchaser to purchase the Property from Seller is subject to satisfaction on or before the Closing of the following conditions (any of which may be waived in whole or in part by Purchaser, but only in writing at or prior to Closing), but a failure to discover, or a waiver of, any circumstances made a condition of this Paragraph 5 shall not constitute a waiver of any warranties and representations provided for elsewhere in this Agreement unless any such waiver specifically so states:

(a) Purchaser shall not have discovered any error, misstatement or omission in the representations or warranties made by Seller in this Agreement. Seller shall afford Purchaser access to the Property to permit Purchaser to verify the representations of Seller made herein and any other conditions;

(b) All warranties and representations made by Seller herein shall be true and correct in all material respects as of Closing;

(c) Purchaser shall have secured an Owner's title insurance policy insuring Purchaser's title in the Property subject only to the Permitted Exceptions;

(d) Seller shall have delivered the documents referred to in Paragraph 9(a), below;

(e) No material restriction, limitations or regulations shall have been issued following the date hereof by any governmental authorities having or asserting jurisdiction over the Property or the ownership thereof which event thereof has an adverse effect on the ownership, use and/or operation of the Property including without limitation, any reduction in the access to the Property and/or the buildable square footage of the Property;

(f) Seller shall not have received (and has no knowledge of) any notice or request from any insurance company or Board of Fire Underwriters (or organization exercising functions similar thereto) or from the holder or servicing agent of the holder of any mortgage encumbering the Property, requesting the performance of any work or alteration in respect of the Property.

(g) The Zoning Contingency (as hereinafter defined in Section 24) shall have been completed.

(h) The successful completion of the Due Diligence Period (as hereinafter defined in Section 23) shall have been completed.

6. Title to Be Conveyed.

At the time of Closing, Seller shall convey or cause to be conveyed to Purchaser by special warranty deed with covenants against grantor's acts, good, marketable and indefeasible title in fee simple to the Property free and clear of any and all liens, encumbrances, conditions, easements, assessments, restrictions, except those of record or for the Permitted Exceptions. Within thirty (30) days following the Agreement Date, Purchaser may conduct such title investigation as it deems appropriate and, if, in the determination of Purchaser, title is unacceptably encumbered, Purchaser may terminate this Agreement. Otherwise, subject to Section 7(b) below, Purchaser shall take title to the Property SUBJECT to the following: (a) building and use restrictions of record; (b) vehicular or pedestrian easements of record affecting the property and being contiguous to the front, rear or side lot line; (c) water, sewer, gas, electric and telephone lines or easements therefor of record or as presently installed; (d) prior grants, reservations or leases of coal, oil, gas or other minerals as shown by instruments of record; and (e) easements apparent upon inspection of the Property.

7. Title Insurance.

(a) Purchaser at its sole cost and expense, shall secure a commitment for an Owner's policy of title insurance (the "Commitment") covering title to the Property.

(b) If the Commitment discloses exceptions to title to the Property other than the Permitted Exceptions (said exceptions to title other than the Permitted Exceptions are hereinafter referred to as "Unpermitted Exceptions"), then Seller may at its option either (a) remedy all such defects, or (b) notify Purchaser within ten (10) days of such notice of defects that Seller is unwilling or unable to correct such defects whereupon Purchaser, within five (5) days of such notice from Seller, may elect to (i) accept whatever title Seller has to the Property without a reduction or abatement of the Purchase Price or (ii) rescind this Agreement of Sale, whereupon the Deposit shall be returned (without either party being deemed at fault).

8. **Closing.** The Closing of the transaction contemplated by this Agreement (the “Closing” or “Closing Date”) shall occur on or about thirty (30) days after the expiration of the Due Diligence Period (as hereinafter defined) and (ii) the satisfaction of the Zoning Contingency (as hereinafter defined), at the offices of Seller’s counsel. In the event the conditions precedent to Purchaser’s obligations on the Closing Date set forth in Paragraph 5 have not been met or waived by Purchaser, then Purchaser shall have the right to terminate this Agreement and receive a return of the Deposit, and upon such termination, this Agreement shall be null, void and of no further force nor effect.

9. **Documents and Deposits Required at Closing.**

(a) On or before the Closing Date, Seller shall deliver to Purchaser the following documents executed and acknowledged where appropriate:

- (i) A special warranty deed with covenant against Seller’s acts in form reasonably satisfactory to Purchaser;
- (ii) An affidavit in the form of Exhibit “D” annexed hereto executed by Seller in form and substance acceptable under Section 1445 of the Internal Revenue Code, as amended, setting forth, under penalty of perjury, Seller’s United States taxpayer identification number and certifying that Seller is not a “foreign person” as that term issued under Section 1445 (b)(2) of the Internal Revenue Code, as amended;
- (iii) Such proof of Seller’s authority and authorization to enter into this transaction as may be required by the Title Insurer; and

(b) On or before the Closing, Purchaser shall deliver to Seller the following, executed and acknowledged where appropriate:

- (i) The balance of the Purchase Price, in accordance with Paragraph 3(b) above;

10. **Possession, Provisions, and Expenses.**

- (a) Sole and exclusive possession of the Property shall be delivered to Purchaser at Closing.
- (b) At Closing, any realty transfer taxes in connection herewith shall be divided equally between Seller and Purchaser. Purchaser shall pay all costs associated with the Commitment, Title Policy and Survey and the recording fees associated with

recording the deed. Purchaser and Seller will pay and be liable for their respective attorneys' fees.

- (c) To the extent that there are any expenses including without limitation real estate taxes and utility charges that have not yet been determined or are not available prior to Closing, Seller shall be responsible on a daily pro-rated basis for all such expenses up to the day before the Closing and Purchaser responsible for all such cost as of the Closing Date.
- (d) The provisions of this Paragraph 10 shall survive the Closing.

11. **Casualty.** In the event of substantial loss or damage to the Property prior to the Closing Date by fire or other casualty, Purchaser may cancel this Agreement, in which event the Deposit shall be immediately refunded, this Agreement shall terminate and neither party shall have any further rights or obligations under this Agreement. In the event that Purchaser shall not elect to terminate, or if the loss or damage is not "substantial," then this Agreement shall remain in full force and effect and Purchaser shall proceed to close and take the Property as damaged, in which event Purchaser shall be entitled to receive the insurable proceeds plus the amount of any deductible, coinsurance or self-insurance carried by Seller so that Purchaser shall receive, in effect, the full replacement cost of the loss or damage, as the cost is determined in the settlement with the property insurer. Seller represents and warrants that it shall keep in full force and affect the insurance until the Closing Date. Seller and Purchaser shall each be entitled to participate in the settlement. As used in this Paragraph 11, the term "substantial loss or damage" means any loss or damage resulting to the Property which the parties reasonably estimate will cost Twenty-Five Thousand Dollars (\$25,000) or more to repair or restore.

12. **Condemnation.** In the event, prior to the Closing Date, all or any part of the Property is taken by eminent domain, then Purchaser, at Purchaser's option, shall elect to either (i) terminate this Agreement, in which event the Deposit shall be returned to Purchaser and the parties shall have no further rights or liabilities with respect to each other or (ii) have the transaction be consummated in accordance with the terms hereof without a reduction in the Purchase Price and, at Closing, Seller shall assign to Purchaser any and all rights to any award payable as a result of such eminent domain proceeding.

13. **Notices.** All notices required hereunder shall be in writing and shall be deemed to have been duly given and received two (2) business days after depositing of the same in the mail if sent by registered or certified mail, postage prepaid, to the party to whom directed, at such party's address herein set forth, or upon delivery, or attempted delivery if delivered by overnight courier service or hand delivered, or upon the same day on which successful transmission is confirmed by

the Sender's facsimile machine, if by facsimile. Any party shall have the right to designate any other address for notice purposes by written notice to the other party in the manner aforesaid. The addresses of the parties are as follows:

PURCHASER: Mount Alvernia Day Care and Learning Center
146 Hawthorne Road
Pittsburgh, PA 15209

with copy to Joseph F. Weis, Esq.
c/o CFWWS Law Firm
2605 Nicholson Road #2201
Wexford, PA 15143

SELLER: Shaler Area School District
1800 Mt. Royal Blvd.
Glenshaw, PA 15116

with copy to Matthew M. Hoffman, Esq.
Tucker Arensberg Attorneys
1500 One PPG Place
Pittsburgh, PA 15222

14. **Brokerage Commission.** Purchaser and Seller each represent and warrant to the other that it has not dealt with any real estate broker, salesman or finder in connection with this transaction except for Massaro Properties, LLC whose commission shall be paid by Purchaser. Purchaser and Seller each agree to indemnify and hold the other harmless from and against any claims, liabilities, damages, costs and expenses (including but not limited to court costs and reasonable attorney's fees) suffered or incurred by the other on account of a breach of the above representation and warranty. The provisions of this Paragraph shall survive the Closing.

15. **Default.**

(a) In the event Seller shall fail to comply with any of its obligations to be performed by Seller hereunder on or prior to the Closing Date, then Purchaser shall be entitled to all remedies available to it at both law and equity.

(b) In the event of default by Purchaser: (i) Purchaser shall be liable to Seller for all attorneys fees, costs and expenses incurred in obtaining court approval as provided in Section 25 below; and (ii) Seller shall retain the Deposit as liquidated damages, and, upon receipt of such monies by Seller, this Agreement shall become null and void and both parties shall thereupon be released of all further liability hereunder. It is hereby agreed that, without resale, Seller's damages will be difficult of ascertainment and that the Deposit constitutes a reasonable liquidation thereof and not a penalty.

16. **Effective Date.** The effective date of this Agreement shall be the date of approval of this Agreement by Order of the Court of Common Pleas of Allegheny County as further set forth in Section 25 hereof (the "Effective Date").

17. **Time of Essence.** Seller and Purchaser agree that time is of essence and that failure of either party to substantially comply with the time limitations contained herein shall be considered a default unless provided otherwise herein or unless expressly waived in writing by agreement of non-defaulting party.

18. **Entire Agreement.** This Agreement contains the entire agreement between the parties with respect to the purchase and sale of the Property, and the same may not be modified or discharged nor may any of its terms be waived except by an instrument in writing signed by the parties hereto.

19. **Persons Bound.** This Agreement, and all covenants and provisions herein contained, shall bind and inure to the benefit of the parties hereto and their respective heirs, personal representatives, administrators, executors, successors and permitted assigns.

20. **Further Assurances.** Except as expressly provided herein to the contrary the parties each agree to do, execute, acknowledge and deliver all such further arts, instruments, and assurances and to take all such further action before or after the Closing as shall be necessary or desirable to fully carry out this Agreement and to fully consummate and effect the transaction contemplated hereby.

21. **No Partnership or Joint Venture.** Nothing contained in this Agreement is intended or shall be construed in a manner to create a relationship between Seller and Purchaser other than the relationship of purchaser and seller, and Seller and Purchaser shall not be considered agents of the other, joint ventures, or partners for any purposes.

22. **Right of Revocation.** Purchaser intends to conduct a walk-through of the Premises with one or more construction consultants to assess and advise Purchaser of expected repairs to bring the Property up to all applicable building codes. Seller shall provide Purchaser and its consultant(s) with access to the Property during regular business hours for such purpose. Purchaser shall have until

5:00 p.m. on July 25, 2018, to terminate this Agreement by providing written notice to Seller, whereupon Seller shall promptly remit a refund of the Deposit to Purchaser.

23. Due Diligence Period. At Closing, it is hereby understood between the parties hereto that Purchaser has been afforded the opportunity to inspect the Property, that the Property is being purchased by Purchaser solely in reliance upon such inspection and that there have not been and are no representations or warranties, expressed or implied, made by Seller with respect to the physical condition of the property or its suitability for Purchaser's intended use. Purchaser shall take the Property "AS IS, WITH ALL FAULTS", subject to all defects, whether patent or latent.

Commencing on the Agreement Date and terminating at 5:00 P.M. on the date that is ninety (90) days from the Effective Date (the "**Due Diligence Period**"), Purchaser shall have the right, at its expense, to conduct any and all non-invasive inspections of the Property for the purposes of evaluating all aspects thereof including any and all inspections and tests of the Property as Purchaser deems necessary or appropriate including without limitation environmental inspections, zoning and other local and state regulations. During the Due Diligence Period, Seller and its employees, agents and representatives shall cooperate in all reasonable respects with Purchaser in order to facilitate Purchaser's evaluation. Seller shall furnish Purchaser upon execution of this Agreement, copies of all engineering plans, drawings, surveys, environmental studies and all other information concerning the Property that Seller has in its possession or control.

If and in the event Purchaser determines the Property would require improvements or modifications in excess of \$130,000 to obtain zoning approval as provided in Section 24 below and to bring the Property into compliance with applicable building codes (but not including any improvements necessary for compliance with the Americans With Disabilities Act or similar laws or regulations), then and in such event Purchaser shall have the right to terminate this Agreement and obtain an immediate refund of the Deposit and upon receipt thereof, neither party shall have any further rights and/or liabilities each with respect to the other arising from or out of this Agreement. If and in the event Purchaser fails to deliver a written notice within three (3) business days after the expiration of the Due Diligence Period notifying Seller that Purchaser has elected to go forward with the present transaction contemplated by this Agreement, the Purchaser shall be deemed to have terminated this Agreement.

24. Zoning Contingency. The Closing of the transaction contemplated herein is contingent upon the obtainment by Purchaser, at its cost, of requisite approval by municipal authorities of use of the Property as a day care facility within 180 days from the Agreement Date (the "**Zoning Contingency**"). Purchaser shall exercise diligent effort to apply for and prosecute an application for variance or otherwise obtain such approval promptly following the mutual execution of this Agreement. The Zoning Contingency may be waived in whole or in part by Purchaser in writing at or before Closing.

25. **Court Approval Contingency.** This Agreement of Sale is contingent upon obtainment of approval of the sale of the Property to Purchaser pursuant to the terms and conditions hereof by Order of the Court of Common Pleas of Allegheny County, Pennsylvania, in accordance with Section 707 of the Public School Code, 24 P.S. § 7-707. The preparation and prosecution of such proceedings shall be done by legal counsel for the Seller. All costs of such proceeding, including without limitation attorneys' fees, advertising fees, filing fees and appraiser fees, shall be borne by Seller. Purchaser shall provide reasonable cooperation with Seller in the obtainment of such approval, including appearance of a representative of the Purchaser at any evidentiary hearings before the court to provide necessary testimony. In the event this contingency is not satisfied within ninety (90) days of the date hereof, unless extended upon written notice at the reasonable discretion of the Seller, this Agreement of Sale shall become null and void, the earnest money paid by Purchaser shall be returned and the parties shall have no further obligations under this Agreement except as specifically set forth in this Agreement.

26. **Restrictive Covenant** The Property shall not be used for the purpose of operation of a charter school, private school, parochial school or any other school that would compete for the enrollment of school-aged children that otherwise are eligible for enrollment in the standard curricular programs operated by Seller, provided, however, the foregoing restrictive covenant shall not preclude the conduct on the Property of programs and activities of educational, civic or social benefit to school-aged children that are supplemental to, but not in lieu of, those programs operated by the Seller. This covenant shall be included in the deed delivered to Purchaser at settlement, shall run with the land and shall be binding upon Purchaser, its successors and assigns and any of their respective lessees and licensees.

27. **Coal Notice.** THIS DOCUMENT MAY NOT SELL, CONVEY, TRANSFER, INCLUDE OR INSURE THE TITLE TO THE COAL AND RIGHT OF SUPPORT UNDERNEATH THE SURFACE LAND DESCRIBED OR REFERRED TO HEREIN, AND THE OWNER OR OWNERS OF SUCH COAL AND IN THAT CONNECTION DAMAGE MAY RESULT TO THE SURFACE OF THE LAND AND ANY HOUSE, BUILDING OR OTHER STRUCTURE ON OR IN SUCH LAND. THE INCLUSION OF THIS NOTICE DOES NOT ENLARGE, RESTRICT OR MODIFY ANY LEGAL RIGHTS OR ESTATES OTHERWISE CREATED, TRANSFERRED, EXCEPTED OR RESERVED BY THIS INSTRUMENT. **The deed to the Property shall contain the notice as above set forth and shall contain, and Purchaser shall sign, the notice specified in the Bituminous Mine Subsidence and Land Conservation Act of 1966.**

28. **Non-Solicitation.** Seller agrees that it will not market, nor entertain any offers for the Property through the Due Diligence Period and any additional time required under the process to seek court approval as set forth in Section 25 hereof.

29. Interpretation.

(a) The headings and captions herein are inserted for reference only and the same shall not limit or construe the paragraphs or sections to which they apply or otherwise affect the interpretation hereof.

(b) Words of the masculine, feminine, or neuter gender shall mean and include the correlative words of other genders, and words importing the singular number shall mean and include the plural number and vice versa where the context so requires.

(c) Words importing persons shall include firms, associations, partnerships (including limited partnerships), trusts, corporations, and other legal entities, including public bodies as well as natural persons.

(d) The terms "include", "including" and similar terms shall be constructed as if followed by the phrase "without being limited to".

(e) This Agreement and any document or instrument executed pursuant hereto may be executed in any number of counterparts, each of which shall be deemed an original, but all of which together shall constitute one and the same instrument.

(f) Whenever under the terms of this Agreement the time for performance of a covenant or condition falls upon a Saturday, Sunday, or holiday, such time for performance shall be extended to the next business day. Otherwise all references herein to "days" shall mean calendar days.

(g) This Agreement shall be construed and enforced in accordance with the laws of the State of Pennsylvania.

(h) The recitals to this Agreement are hereby incorporated in the body hereof as if fully set forth herein.

IN WITNESS WHEREOF, the parties hereto have executed this Agreement as of the day and year first above written.

PURCHASER:

MOUNT ALVERNIA DAY CARE AND LEARNING CENTER

By: Christopher Sulka

Name/Title: President, Mount Alvernia Day Care and Learning Center

SELLER:

SHALER AREA SCHOOL DISTRICT

By: _____

Name/Title:

LIST OF EXHIBITS

Exhibit A	Legal Description
Exhibit B	Existing Contracts
Exhibit C	Permitted Exceptions
Exhibit D	FIRPTA Affidavit

EXHIBIT "A"

LEGAL DESCRIPTION

To be provided

EXHIBIT "B"

EXISTING CONTRACTS

None

EXHIBIT "C"

PERMITTED EXCEPTIONS

1. Building and use restrictions of record.
2. Vehicular or pedestrian easements of record affecting the property and being contiguous to the front, rear or side lot line.
3. Water, sewer, gas, electric and telephone lines or easements therefor of record or as presently installed.
4. Prior grants, reservations or leases of coal, oil, gas or other minerals as shown by instruments of record.
5. Easements apparent upon inspection of the Property.
6. Lease Agreement dated July 20, 2011, with Shaler Township

EXHIBIT "D"

Section 1445 of the Internal Revenue Code of 1986, as amended (the "Code"), provides that a transferee of a U.S. real property interest must withhold tax if the transferor is a foreign person. To inform Mount Alvernia Day Care and Learning Center (the "Transferee") that withholding of tax is not required upon disposition of a U.S. real property interest by the Shaler Area School District (the "Transferor"), the undersigned hereby certifies the following on behalf of the Transferor:

1. Transferor is not a foreign corporation, foreign partnership, foreign trust or foreign estate (as those terms are defined in the Code and Income Tax Regulations);
2. The U.S. employer identification number of Transferor is Shaler Area School District;
3. Transferor has an address at 1800 Mt. Royal Blvd., Glenshaw, PA 15116; and
4. The address of the subject property is 201 Wetzell Road, Glenshaw, PA 15116

Transferor understands that this Certification may be disclosed to the Internal Revenue Service by Transferee and that any false statement contained herein could be punished by fine, imprisonment or both.

Under penalties of perjury, I declare that I have examined this Certification and to the best of my knowledge and belief it is true, correct and complete, and I further declare that I have the authority to sign this document on behalf of Transferor.

Shaler Area School District

By: _____
President, Board of School Directors

**SWORN AND SUBSCRIBED TO BEFORE
ME THIS ____ DAY OF _____, 2018**

Notary Public